

APPROVED: _____
 DATE: _____ TITLE: _____

Rev	AWO #	Description	Date	Appr
-		RELEASED	11/2/11	
A		UPDATE CENTER PIN DIA	10/14/14	AY

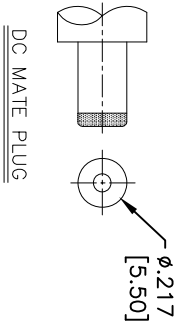

ADAM P/N	Center Pin Dia
ADC-002A-1-N-RT1	.078 [2.00 mm]
ADC-002A-2-N-RT1	.098 [2.50 mm]
ADC-002A-9-N-RT1	.065 [1.65 mm]

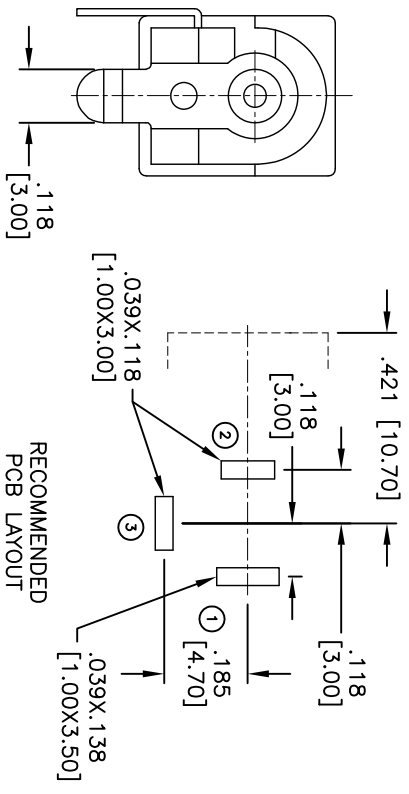
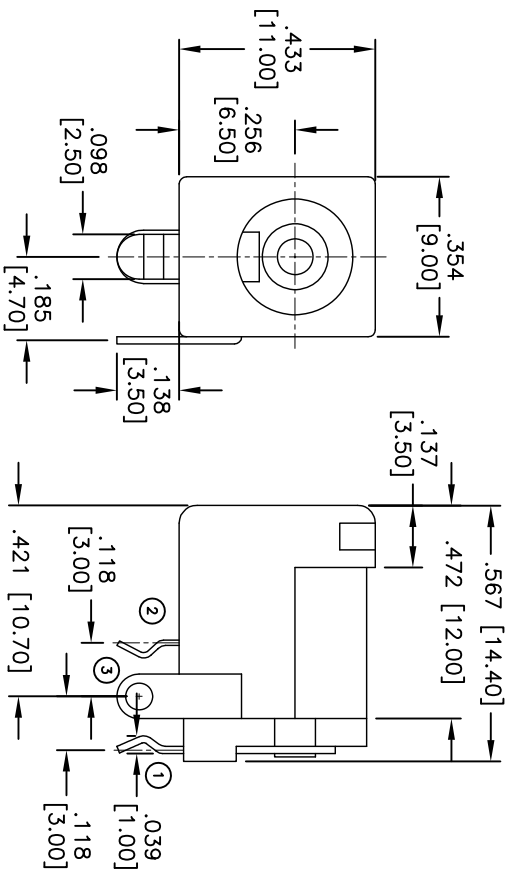
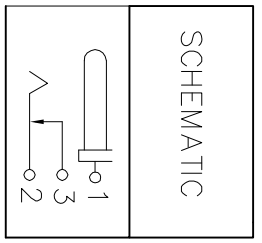

SPECIFICATIONS:
 Material: PBT, rated UL 94V-0
 Insulator color: Black
 Contacts: Copper alloy
 Center pin: Copper, Nickel Plated
 Plating: Tin over Copper underplate overall
 Electrical:
 Operating voltage: 16 VDC max
 Current rating: 2.5 Amp max
 Contact resistance: 50 mohms max
 Insulation resistance: 100 Mohms min
 Dielectric withstanding voltage: 500 VAC for 1 minute
 Temperature Rating:
 Operating temperature: -40°C to +85°C
 Environmental:
 Lead free, RoHS compliant.



ADAM TECH

909 Rahway Avenue, Union, NJ 07083
 Phone: 908-687-5000 Fax: 908-687-5710

TITLE
 DC POWER JACK, NOTCHED HOUSING
 1.65mm, 2.0mm, 2.5mm DIA. CENTER PIN

UNLESS OTHERWISE SPECIFIED ALL DIMENSIONS ARE INCHES [MM]	
TOLERANCES: EXCEPT AS NOTED	
INCHES	HOLDS
.X ± .10	ØXX ± .10
.XX ± .020	ØXXX ± .015
.XXX ± .015	ØXXXX ± .010
APPROVALS	
DRAWN	AY
CHECKED	NP
DATE	11/2/11
APPROVED	

REF:	SIZE	PART NO.	SCALE:	SHEET	REV.
S00021C	X	ADC-002A-X+N-RT1	NIS	1 OF 1	A