

Rev	AWO #	Description	Date	Appr
-		Redrawn	1/17/07	

APPROVED: _____
 DATE: _____ TITLE: _____

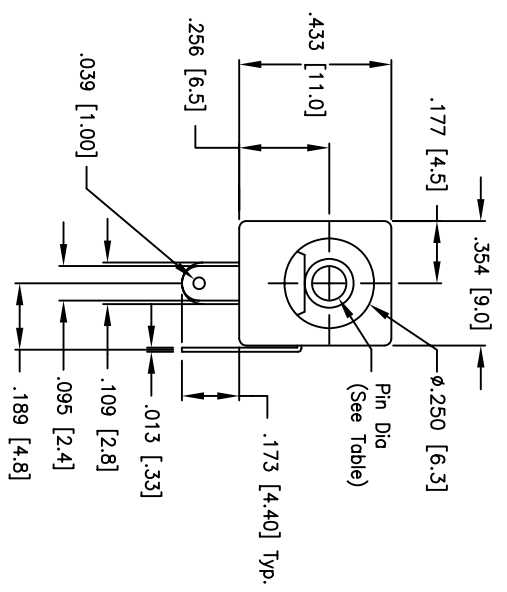

P/N	Center Pin Dia
ADC-002A-1	2.00 mm
ADC-002A-5	2.35 mm
ADC-002A-2	2.50 mm

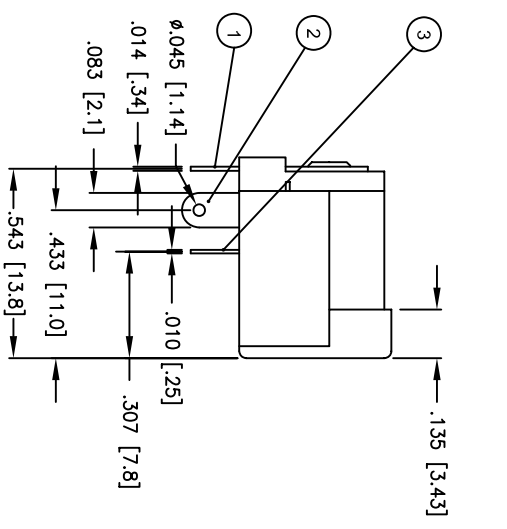
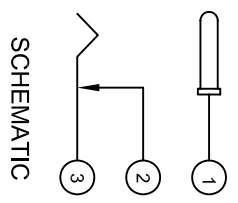
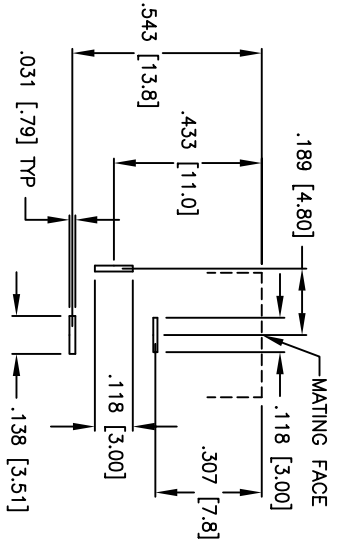
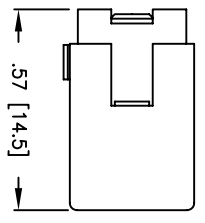

RECOMMENDED PCB LAYOUT (COMPONENT SIDE)
 Tolerances: ±.005 [0.127]

SPECIFICATIONS:

Material:
 Insulator: PBT, Glass Reinforced, rated UL 94V-0
 Insulator color: Black
 Center Pin: Brass, Nickel plated
 Contacts: Copper Alloy
 Plating:
 Silver over Nickel underplate

Electrical:
 Operating voltage: 12 VDC max
 Current rating: 1 Amp max
 Contact resistance: 30 mohms max
 Insulation resistance: 50 Mohms min @ 500 VDC
 Dielectric withstanding voltage: 250 VAC for 1 minute
 Temperature Rating:
 Operating temperature: -25°C to +70°C

Environmental:
 Lead free, RoHS compliant.
 Recommended soldering temp: 235°C for 5 sec.



ADAM TECH

909 Rahway Avenue, Union, NJ 07083
 Phone: 908-687-5000 Fax: 908-687-5710

"X" mm Center Pin, DC Power Jack

UNLESS OTHERWISE SPECIFIED ALL DIMENSIONS ARE MM [INCHES] TOLERANCES: EXCEPT AS NOTED		TITLE	
X	± .10	ØX	± .10
.XX	± .020	ØXX	± .015
.XXX	± .015	ØXXX	± .010
APPROVALS		DATE	
DRAWN	SS	1/17/07	
CHECKED			
APPROVED			
SIZE	PART NO.	REV.	
X	ADC-002A-X-W	-	
SCALE:	NTS	SHEET 1 OF 1	