

Rev	AWO #	Description	Date	Appr
-		RELEASED	11/12/14	

APPROVED: _____
 DATE: _____ TITLE: _____

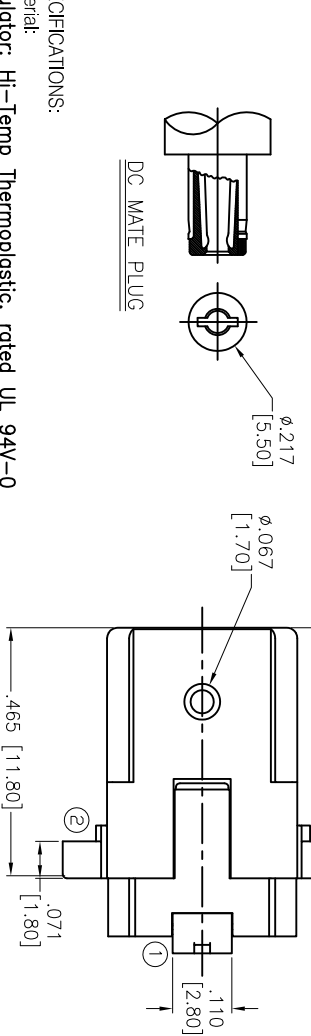

PART NO.	CENTER PIN DIA.
ADC-015A-1-T/R	.079 [2.00]
ADC-015A-2-T/R	.098 [2.50]

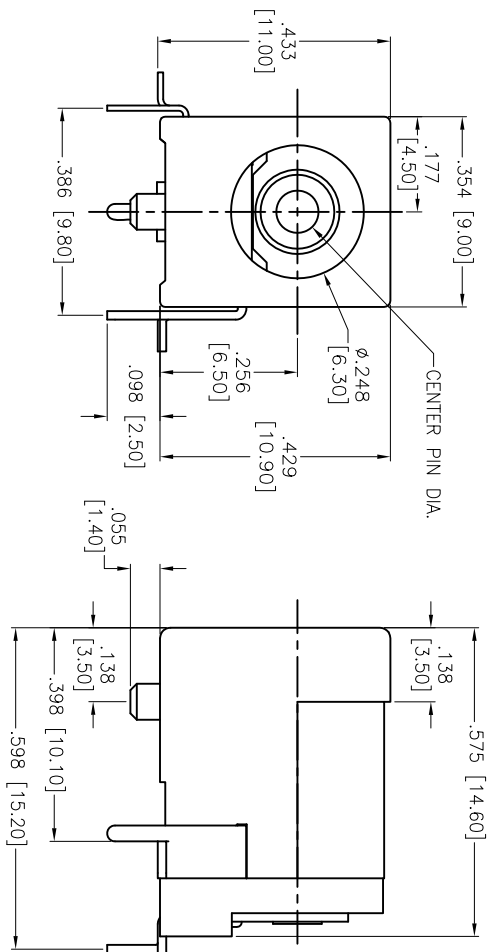
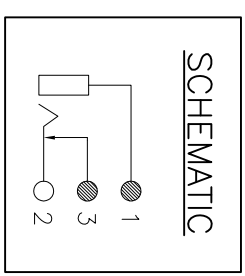

DC MATE PLUG

**DC POWER JACK, SMT TYPE,
2.00mm, 2.50mm CENTER PIN**

ADAM TECH
 909 Ratway Avenue, Union, NJ 07083
 Phone: 908-687-5000 Fax: 908-687-5710

SPECIFICATIONS:
 Material: Insulator: Hi-Temp Thermoplastic, rated UL 94V-0
 Insulator color: Black
 Center Pin: Brass, Nickel plated
 Contacts: Copper Alloy
 Plating: Silver over Copper underplate overall
 Electrical: Operating voltage: 16 VDC max.
 Current rating: 5 A max.
 Contact resistance: 30 mohms max. (pin to contact)
 50 mohms max. (plug shield to socket) @ 100 mA
 Insulation resistance: 100 Mohms min @ 500 VAC
 Dielectric withstanding voltage: 1000 VAC for 1 minute
 Temperature Rating: Operating temperature: -20°C to +60°C
 Environmental: Lead free, RoHS compliant

PACKAGED ON TAPE & REEL

UNLESS OTHERWISE SPECIFIED
 ALL DIMENSIONS ARE INCHES [MM]
 TOLERANCES: EXCEPT AS NOTED
 INCHES Holes ±.10
 .XX ±.020 ØXXX ±.015
 .XXX ±.015 ØXXX ±.010

APPROVALS	DATE
DRAWN	HR
CHECKED	GC
APPROVED	

TITLE	SIZE	PART NO.	REV.
DC POWER JACK, SMT TYPE, 2.00mm, 2.50mm CENTER PIN	X	ADC-015A-X-T/R	-

REF: S00052T SCALE: NTS SHEET 1 OF 1

ROHS COMPLIANT