

Rev	AWO #	Description	Date	Appr
-		RELEASED	1/27/15	

APPROVED: \_\_\_\_\_

DATE: \_\_\_\_\_ TITLE: \_\_\_\_\_

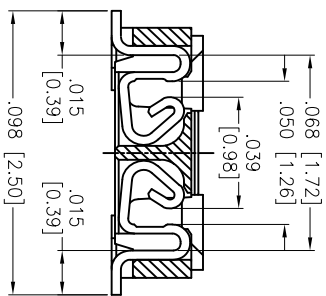

SECTION A-A

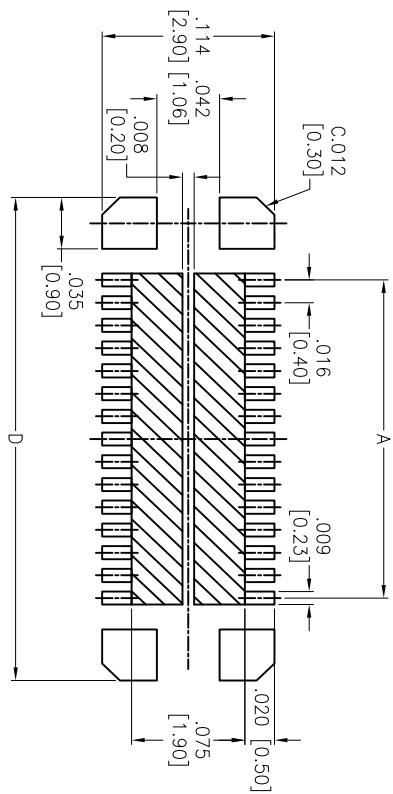
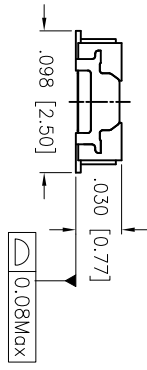
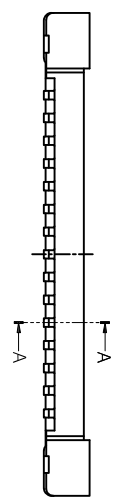
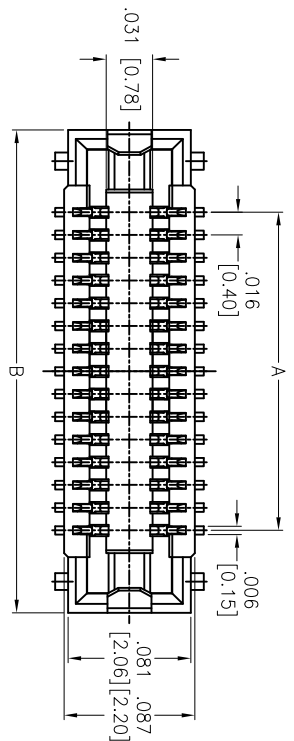

RECOMMENDED PCB LAYOUT

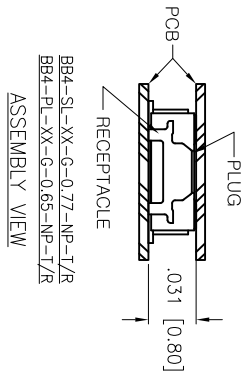
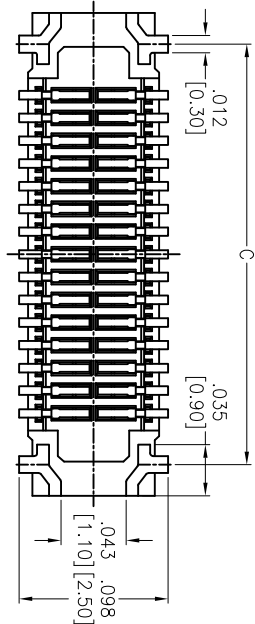

BB4-SL-XX-G-0.77-NP-T/R  
BB4-PL-XX-G-0.65-NP-T/R  
ASSEMBLY VIEW

PACKAGED ON TAPE & REEL  
Positions: 10, 12, 16, 24, 30, 34, 40

- A = .016 [0.40] x No. of Space
- B = .016 [0.40] x No. of Positions per Row + .098 [2.50]
- C = .016 [0.40] x No. of Positions per Row + .055 [1.40]
- D = .016 [0.40] x No. of Positions per Row + .098 [2.50]

**ADAM TECH**

909 Rahway Avenue, Union, NJ 07083  
Phone: 908-687-5000 Fax: 908-687-5710

TITLE: .016 [0.40] BOARD TO BOARD RECEPTACLE  
SURFACE MOUNT, 0.77MM HEIGHT

**SPECIFICATIONS:**  
Material: Insulator: Hi-Temp Thermoplastic, rated UL 94V-0  
Insulator color: Black  
Contacts: Titanium Copper  
Fitting Nail: Phosphor Bronze, Gold Flash Plated  
Plating: Gold flash over Nickel underplate overall  
Electrical: Operating voltage: 60 VAC  
Current rating: 0.3 A per Pin (All pins 5A max)  
Contact resistance: 60 mohms max.  
Insulation resistance: 1,000 Mohms min. @ 250 VDC  
Dielectric withstanding voltage: 250 VAC for 1 minute  
Temperature Rating: Operating temperature: -55°C to +85°C  
Environmental: Lead free, RoHS compliant



UNLESS OTHERWISE SPECIFIED ALL DIMENSIONS ARE INCHES [MM] TOLERANCES: EXCEPT AS NOTED		TITLE	
INCHES		.016 [0.40] BOARD TO BOARD RECEPTACLE	
Holes		SURFACE MOUNT, 0.77MM HEIGHT	
.X ± .10	ØXX ± .10	SIZE	PART NO.
.XX ± .020	ØXXX ± .015	X	BB4-SLK-XX-G-0.77-NP-T/R
.XXX ± .015	ØXXX ± .010	REF:	S00153T
APPROVALS		SCALE:	NTS
DRAWN	HR	DATE	1/27/15
CHECKED	CH	DATE	1/27/15
APPROVED		REV.	-