

Rev	AWO #	Description	Date	Appr
-		RELEASED	9/9/13	

APPROVED: \_\_\_\_\_  
 DATE: \_\_\_\_\_ TITLE: \_\_\_\_\_

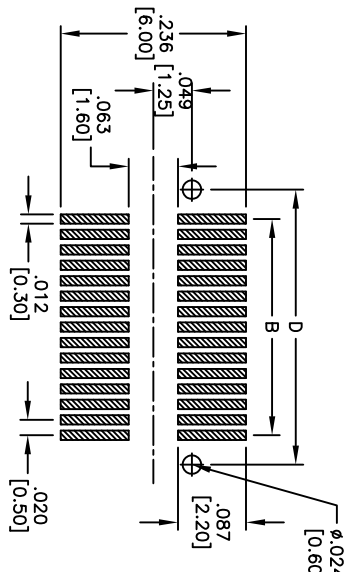
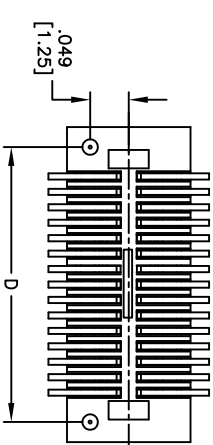
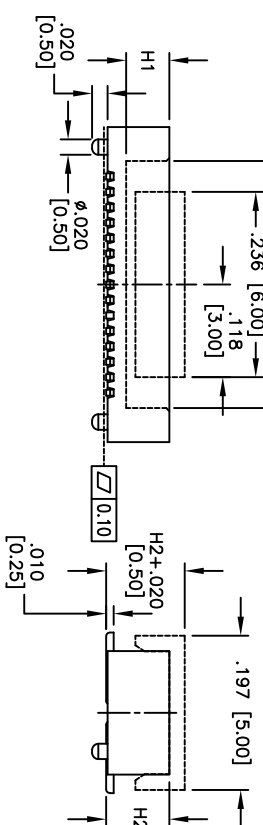
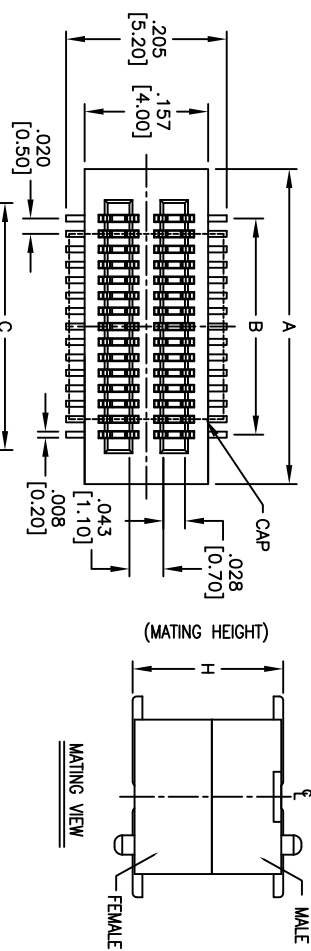

PACKAGED ON TAPE & REEL

ADAM P/N	XXX (H2)	(H1)	Plug Height (H1)	Mating Height (H)
BB5-SXI-XXX-G-2.05-PP-T/R	.081 [2.05]	.055 [1.40]	.033 [0.85]	.118 [3.00]
BB5-SXI-XXX-G-2.05-PP-T/R	.081 [2.05]	.055 [1.40]	.053 [1.35]	.138 [3.50]
BB5-SXI-XXX-G-2.05-PP-T/R	.081 [2.05]	.055 [1.40]	.073 [1.85]	.157 [4.00]
BB5-SXI-XXX-G-3.45-PP-T/R	.136 [3.45]	.079 [2.00]	.037 [0.95]	.177 [4.50]
BB5-SXI-XXX-G-3.45-PP-T/R	.136 [3.45]	.079 [2.00]	.057 [1.45]	.197 [5.00]
BB5-SXI-XXX-G-3.45-PP-T/R	.136 [3.45]	.079 [2.00]	.077 [1.95]	.217 [5.50]
BB5-SXI-XXX-G-3.45-PP-T/R	.136 [3.45]	.079 [2.00]	.096 [2.45]	.236 [6.00]

SPECIFICATIONS:  
 Material: Insulator: Hi-temp thermoplastic, rated UL 94V-0  
 Insulator color: White  
 Contacts: Phosphor Bronze  
 Plating: Gold flash over Nickel underplate overall  
 Electrical: Operating voltage: 50 VAC max.  
 Current rating: 0.5 Amps max.  
 Contact resistance: 50 mohms max. initial  
 Insulation resistance: 50 Mohms min.  
 Dielectric withstanding voltage: 250 VAC for 1 minute  
 Temperature Rating: Operating temperature: -20°C to +85°C  
 Environmental: Lead free, RoHS compliant

**ADAM TECH**

909 Railway Avenue, Union, NJ 07083  
 Phone: 908-687-5000 Fax: 908-687-5710

.031 [0.50] PITCH BOARD TO BOARD  
 SOCKET, SMT TYPE

UNLESS OTHERWISE SPECIFIED  
 ALL DIMENSIONS ARE IN INCHES [MM]  
 TOLERANCES: EXCEPT AS NOTED  
 INCHES: .X ± .10 ØXX ± .10  
 .XX ± .020 ØXXX ± .015  
 .XXX ± .015 ØXXXX ± .010  
 APPROVALS: \_\_\_\_\_ DATE: \_\_\_\_\_  
 DRAWN: AY 9/9/13  
 CHECKED: YC 9/9/13  
 APPROVED: \_\_\_\_\_  
 SIZE: X  
 PART NO.: BB5-SXI-XXX-G-XXX-PP-T/R  
 REF: S00116C SCALE: NTS SHEET 1 OF 1