

| Rev | AWO # | Description       | Date    | Appr |
|-----|-------|-------------------|---------|------|
| -   |       | RELEASED          | 5/24/06 |      |
| A   |       | REVISED DIMENSION | 5/30/06 |      |
| B   |       | REVISED DIMENSION | 5/18/10 |      |

APPROVED: \_\_\_\_\_  
 DATE: \_\_\_\_\_ TITLE: \_\_\_\_\_

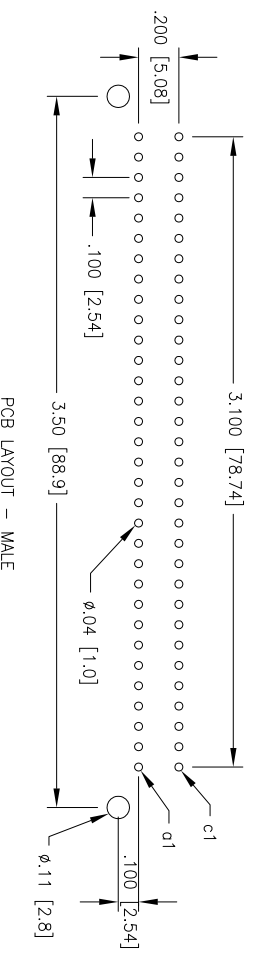
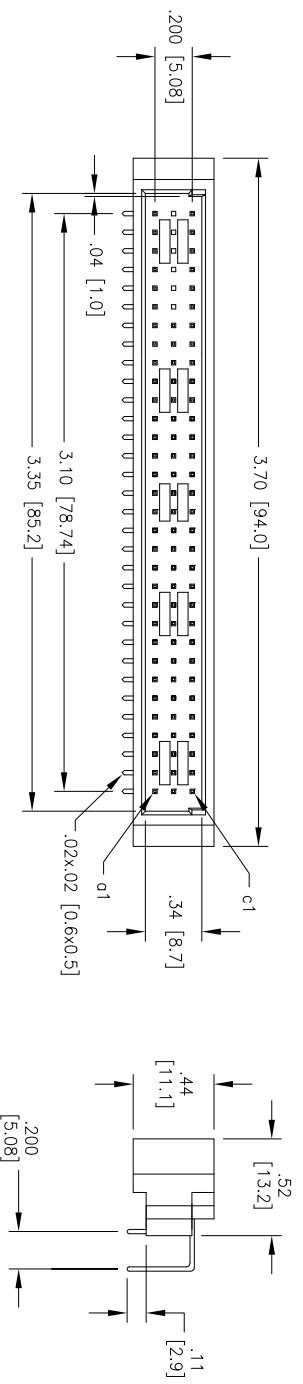
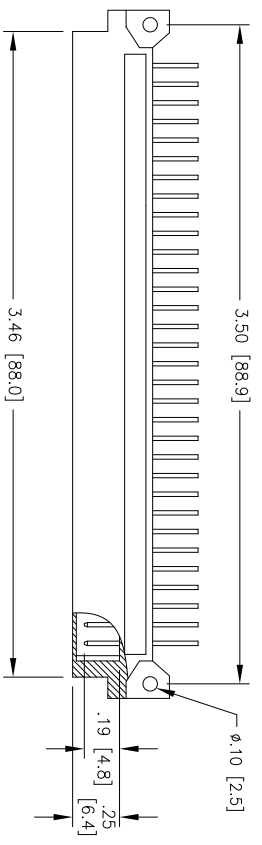

| "X" | PLATING    |
|-----|------------|
| C1  | 30 u" Gold |
| C2  | 15 u" Gold |
| C3  | Gold Flash |

PCB LAYOUT - MALE

**SPECIFICATIONS:**  
 Material: PBT, glass reinforced, rated UL 94V-0  
 Insulator color: Beige  
 Contacts: Brass  
 Plating:  
 X Gold over Nickel on contact area, Tin over Copper underplate on tails  
 Electrical:  
 Operating voltage: 5000 VAC max  
 Current rating: 2 Amps max  
 Contact resistance: 30 mohms max  
 Insulation resistance: 100 Mohms min @ 500 VDC  
 Dielectric withstanding voltage: 1000 VAC for 1 minute  
 Temperature Rating:  
 Operating temperature: -55°C to +125°C

**Environmental:**  
 Lead free, RoHS compliant.



UNLESS OTHERWISE SPECIFIED  
 ALL DIMENSIONS ARE MM [INCHES]  
 TOLERANCES: EXCEPT AS NOTED  
 INCHES ± .10  
 .XX ± .020  
 .XXX ± .015  
 HOLES ØXX ± .10  
 ØXXX ± .015  
 DATE

|          |    |         |
|----------|----|---------|
| DRAWN    | SS | 5/24/06 |
| CHECKED  |    |         |
| APPROVED |    |         |

**ADAM TECH**  
 909 Rahway Avenue, Union, NJ 07083  
 Phone: 908-687-5000 Fax: 908-687-5710

|       |                                      |              |
|-------|--------------------------------------|--------------|
| TITLE | DIN 41612, 96 POSITION MALE R/A, ROW |              |
| SIZE  | PART NO.                             | REV.         |
| X     | DIN-64MR-L32-A1CX                    | B            |
| REF:  | SCALE: NTS                           | SHEET 1 OF 1 |