

Rev	AWO #	Description	Date	Appr
-		RELEASED	4/22/15	

APPROVED: _____
 DATE: _____ TITLE: _____

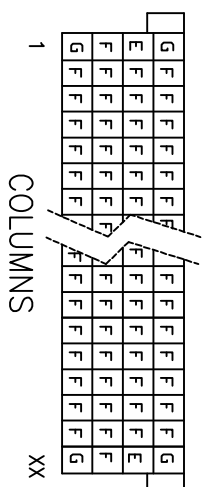
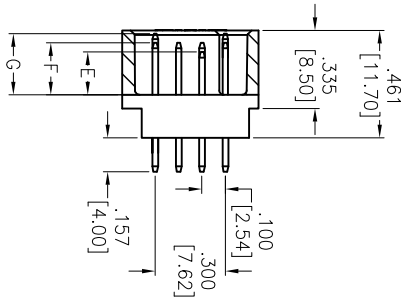
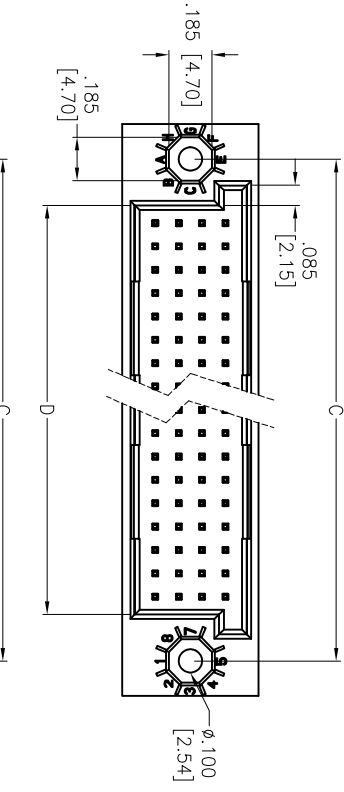
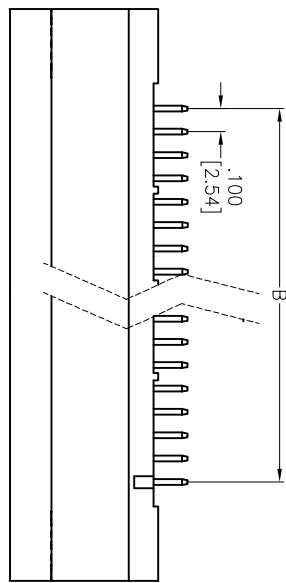

RECOMMENDED PCB LAYOUT

"X"	PLATING
C1	30 u" Gold
C2	15 u" Gold
C3	Gold Flash

Contact Length	E	F	G	D
183 [4.65]	.222 [5.65]	.262 [6.65]		
100	3.250 [82.53]	2.400 [60.96]	2.950 [74.93]	2.550 [65.02]
128	3.950 [100.33]	3.100 [78.74]	3.650 [92.71]	3.250 [82.80]
160	4.750 [120.65]	3.900 [99.06]	4.450 [113.03]	4.050 [103.12]
200	5.750 [146.05]	4.900 [124.46]	5.450 [138.43]	5.050 [128.52]
240	6.750 [171.45]	5.900 [149.86]	6.647 [168.83]	6.050 [153.92]

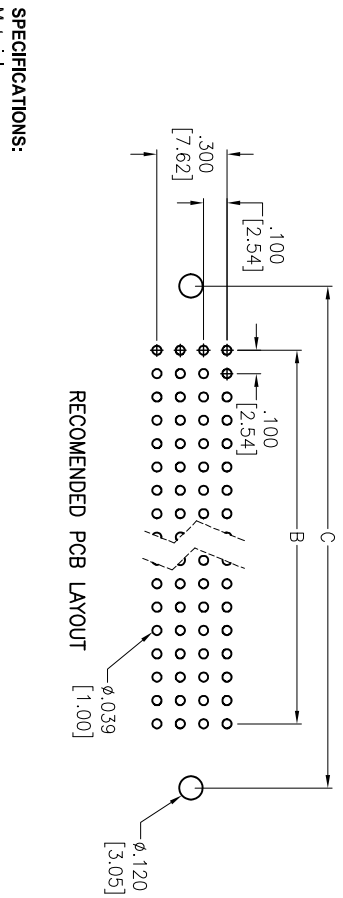

SPECIFICATIONS:
 Material: _____
 Insulator: Hi-Temp Thermoplastic, rated UL 94V-0
 Contacts: Copper Alloy

Plating:
 Gold over Nickel underplate on contact area,
 Tin over Copper underplate on solder tails.
 (See chart for thickness)

Electrical:
 Current rating: 2 Amps max
 Contact resistance: 20 mohms max
 Insulation resistance: 1000 Mohms min
 Dielectric withstanding voltage: 1000 VAC for 1 minute

Temperature Rating:
 Operating temperature: -55°C to +125°C
 Environmental: _____

Lead free, RoHS compliant.



UNLESS OTHERWISE SPECIFIED
 ALL DIMENSIONS ARE MM [INCHES]
 TOLERANCES: EXCEPT AS NOTED
 INCHES

.X	± .10	ØX	± .10
.XX	± .020	ØXXX	± .015
.XXX	± .015	ØXXX	± .010

APPROVALS

DRAWN	AY	4/22/15
CHECKED	AC	4/22/15
APPROVED		

ADAM TECH
 909 Railway Avenue, Union, NJ 07083
 Phone: 908-687-5000 Fax: 908-687-5710

TITLE: **DIN 41612, MALE, STRAIGHT PCB MOUNT**

SIZE	PART NO.	SCALE	SHEET	REV.
X	DIN-XXX-MS-L44-A1CX-HT	NIS	1 OF 1	-
REF:	S00038T			