

Rev	AWO #	Description	Date	Appr
-		RELEASED	1/09/09	

APPROVED: _____
 DATE: _____ TITLE: _____

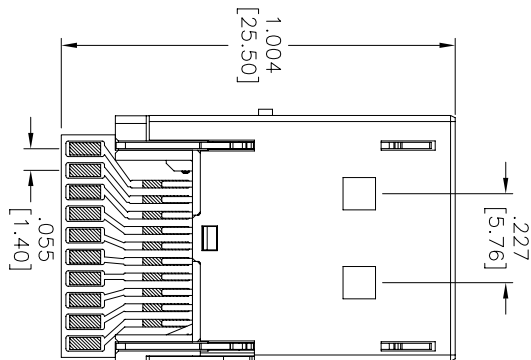
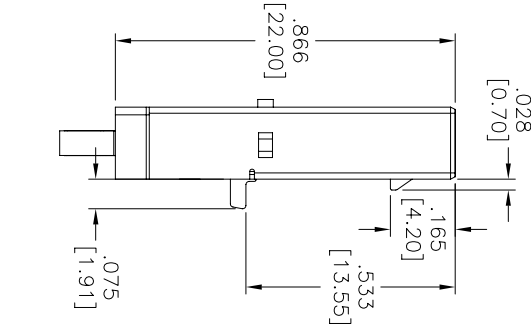
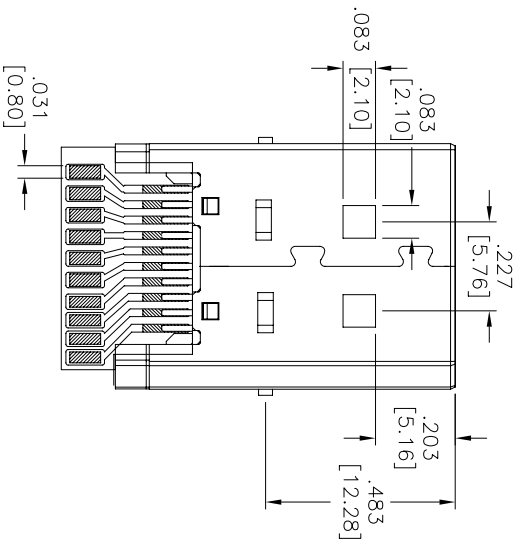
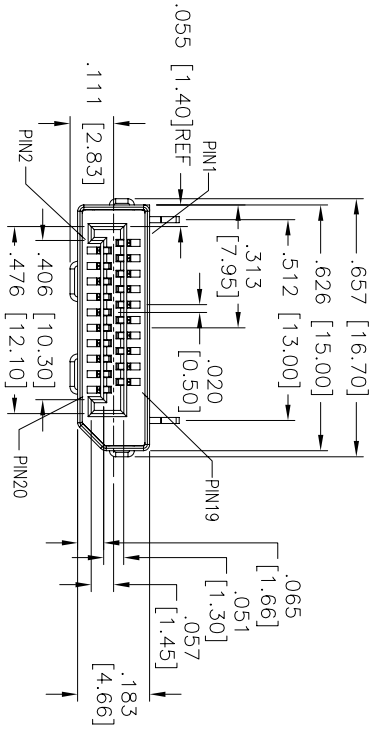

SPECIFICATIONS:

- Material:** Housing: LCP, rated UL 94V-0
- Contact:** Copper Alloy
- Shell:** Copper Alloy, nickel plated
- Plating:** 15u" Gold over Nickel underplate overall
- Electrical:** Operating voltage: 40 VAC
- Current rating:** 0.5 Amps min
- Withstanding Voltage:** 500V AC for 1 minute
- Insulation Resistance:** 100M ohms min.
- Conduct Resistance:** 30 ohms max.
- Temperature Rating:** Operating temperature: -25°C to +85°C
- Environment:** Lead free, RoHS compliant.
- Recommended soldering temp:** 260°C for 5 sec.

UNLESS OTHERWISE SPECIFIED
 ALL DIMENSIONS ARE IN INCHES [MM]
 TOLERANCES: EXCEPT AS NOTED

INCHES	HOLES
.X ± .10	ØX ± .10
.XX ± .020	ØXX ± .015
.XXX ± .015	ØXXX ± .010

APPROVALS: _____ DATE: _____

DRAWN	DY	1/09/09
CHECKED		
APPROVED		

ADAM TECH
 909 Railway Avenue, Union, NJ 07083
 Phone: 908-687-5000 Fax: 908-687-5710

TITLE
 DISPLAYPORT 20 PIN PLUG, ASSEMBLY TYPE
 15 u" GOLD PLATED

SIZE	PART NO.	DPC-M-SD-15	REV.
X			-

REF: S00106T SCALE: NTS SHEET 1 OF 1