

APPROVED: _____
 DATE: _____ TITLE: _____

Rev	AWO #	Description	Date	Appr
-		RELEASED	5/11/05	
A		REDRAWN	6/27/08	

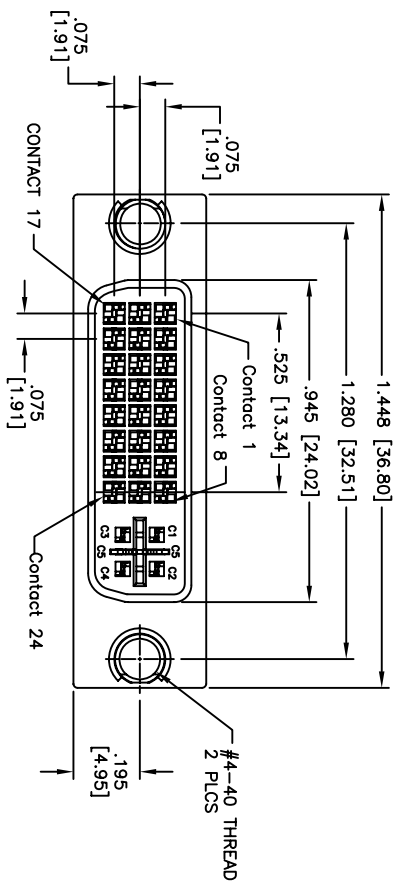

RECOMMENDED
PCB LAYOUT

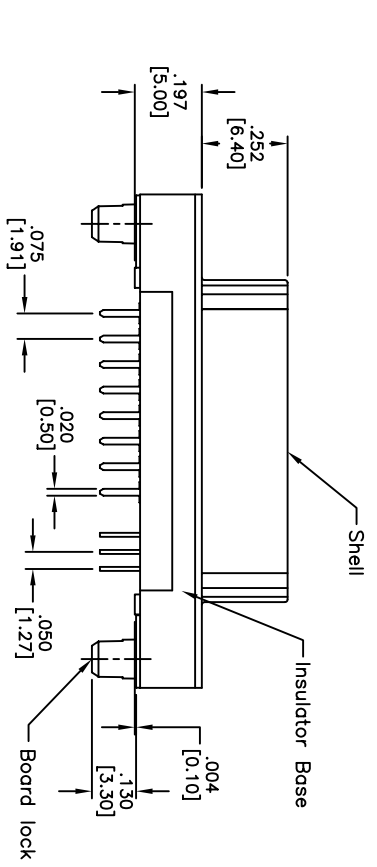
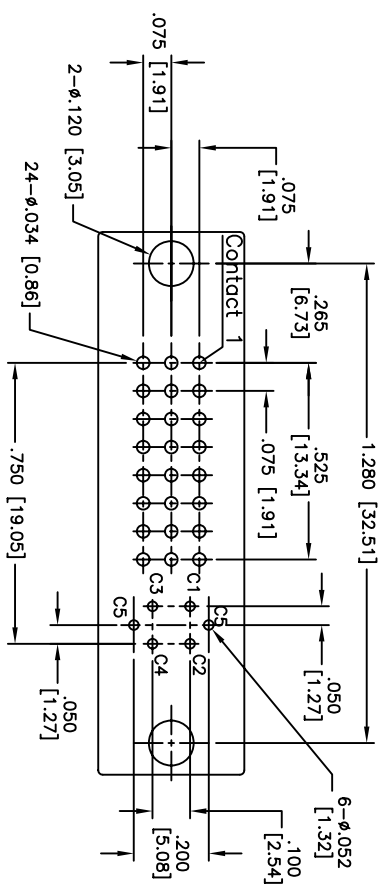

SPECIFICATIONS:

Material:
 Insulator: PBT, glass reinforced, rated UL 94V-0
 Insulator color: White
 Contacts: Phosphor Bronze
 Shell: Steel, Nickel plated
 Plating:
 Gold flash over Nickel underplate on mating area,
 Tin over Copper underplate on tails
Electrical:
 Operating voltage: 250 VAC max
 Current rating: 1.5 Amps max
 Contact resistance: 20 mohms max
 Insulation resistance: 1,000 Mohms min
 Dielectric withstanding voltage: 500 VAC for 1 minute
Temperature Rating:
 Operating temperature: -20°C to +80°C
Environmental:
 Lead free, RoHS compliant
 Recommended soldering temp: 235°C for 5 seconds

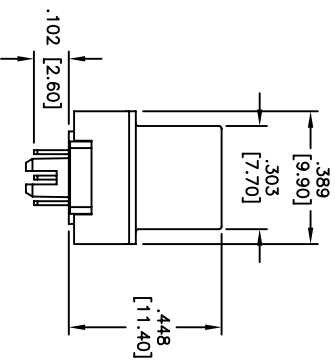

A

UNLESS OTHERWISE SPECIFIED
 ALL DIMENSIONS ARE IN INCHES [MM]
 TOLERANCES: EXCEPT AS NOTED
 INCHES: .X ±.10 ØXX ±.015
 .XX ±.020 ØXXX ±.010
 .XXX ±.015

ADAM TECH
 909 Railway Avenue, Union, NJ 07083
 Phone: 908-687-5000 Fax: 908-687-5710

TITLE: DIGITAL VIDEO INTERFACE SOCKET
 STRAIGHT PCB TAILS, ANALOG

APPROVALS	DATE	SIZE	PART NO.	DIV-ST	REV.
DRAWN	SS	5/11/05	DVI-ST-24-2		A
CHECKED					
APPROVED					

A

B

C

D