

Rev	AWO #	Description	Date	Appr
-		RELEASED	11/07/11	

APPROVED: \_\_\_\_\_  
 DATE: \_\_\_\_\_ TITLE: \_\_\_\_\_

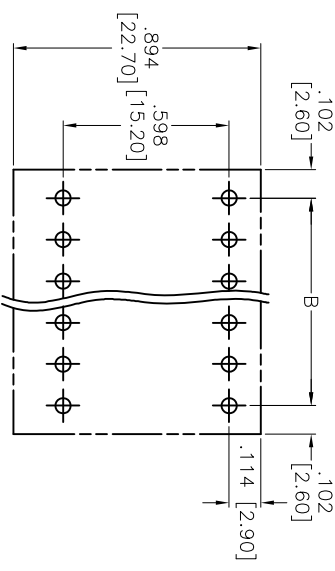

RECOMMENDED PCB LAYOUT

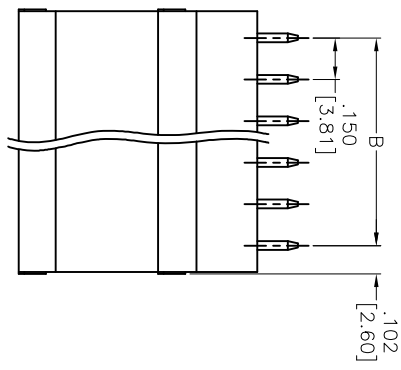
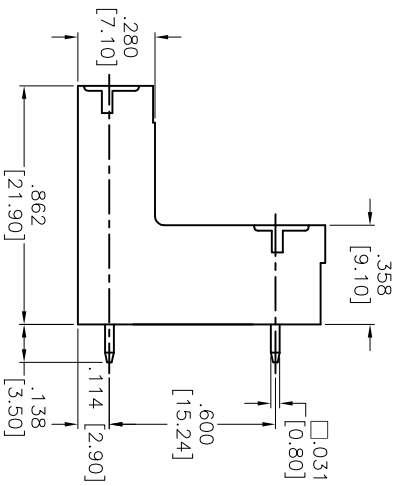
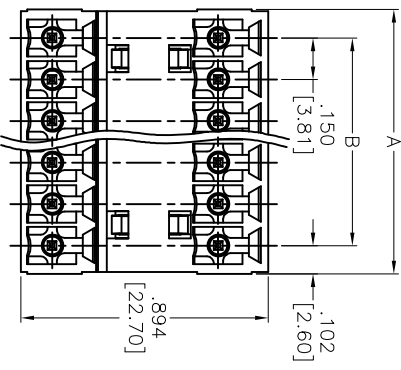

Positions: 2x02 thru 2x24  
 A = .150 [3.81] x No. of Spaces + .205 [5.20]  
 B = .150 [3.81] x No. of Spaces

	Tolerance
4-10P	±.006 [0.15]
12-20P	±.008 [0.20]
22-30P	±.010 [0.25]
32-40P	±.012 [0.30]
42-48P	±.014 [0.35]

**SPECIFICATIONS:**

**Material:**  
 Insulator: PA66, rated UL 94V-0  
 Insulator color: Green  
 Contact: Copper Alloy, Tin plated  
 Electrical:  
 Operation voltage: 300 VAC  
 Current rating: 10 Amps  
 Withstanding Voltage: 1.6kV  
 Temperature Rating:  
 Operating temperature: -40°C to +115°C  
 Environmental:  
 Lead free, RoHS compliant.



**ADAM TECH**

909 Rahway Avenue, Union, NJ 07083  
 Phone: 908-687-5000 Fax: 908-687-5710

EURO BLOCK, .150 [3.81] PITCH, VERTICAL

UNLESS OTHERWISE SPECIFIED	
ALL DIMENSIONS ARE INCHES [MM]	
TOLERANCES EXCEPT AS NOTED	HOLDERS
.X ±.10	ØX ±.10
.XX ±.020	ØXX ±.015
.XXX ±.015	ØXXX ±.010

APPROVALS	DATE
DRAWN TW	11/07/11
CHECKED AY	11/07/11
APPROVED	

SIZE	PART NO.	REV.
X	EB8-XX-B-VT	-

REF: S00007T SCALE: NTS SHEET 1 OF 1