

6

5

4

3

2

1

APPROVED: \_\_\_\_\_ TITLE: \_\_\_\_\_  
 DATE: \_\_\_\_\_

| Rev | AWO # | Description     | Date     | Appr  |
|-----|-------|-----------------|----------|-------|
| -   |       | RELEASED        | 10/03/12 |       |
| A   |       | UPDATED DRAWING | 8/14/15  | HR/AY |

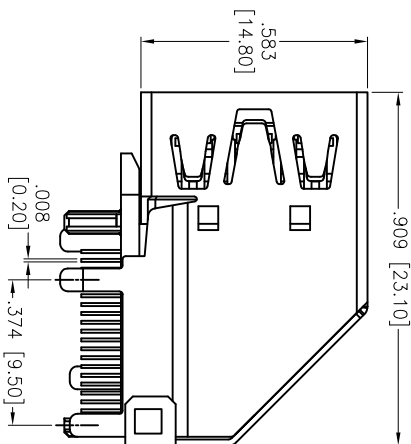
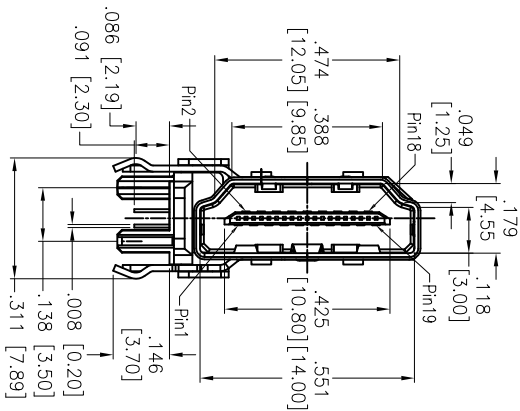
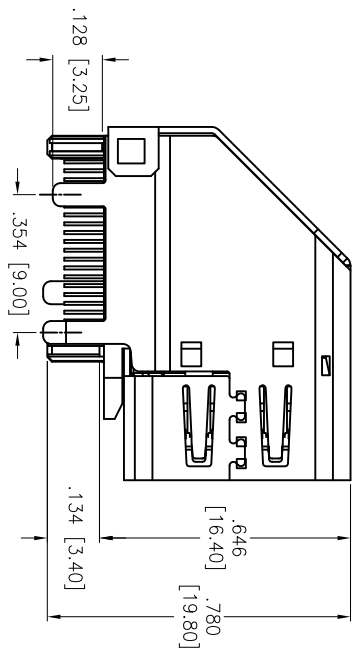

| No. | Signal Name       | No. | Signal Name                            |
|-----|-------------------|-----|--|
| 1   | TMDS Data2+       | 11  | TMDS Clock Shield                      |
| 2   | TMDS Data2 Shield | 12  | TMDS Clock-                            |
| 3   | TMDS Data2-       | 13  | CEC                                    |
| 4   | TMDS Data1+       | 14  | Reserved (in cable but N/C. on device) |
| 5   | TMDS Data1 Shield | 15  | SCL                                    |
| 6   | TMDS Data1-       | 16  | SDA                                    |
| 7   | TMDS Data0+       | 17  | DDC/CEC Ground                         |
| 8   | TMDS Data0 Shield | 18  | +5V Power                              |
| 9   | TMDS Data0-       | 19  | Hot Plug Detect                        |
| 10  | TMDS Clock+       |     |  |

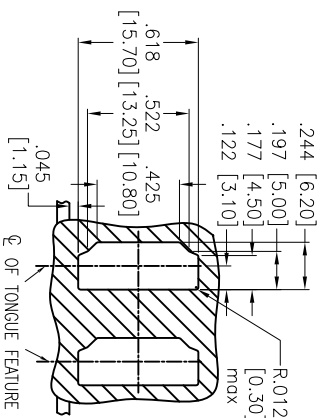
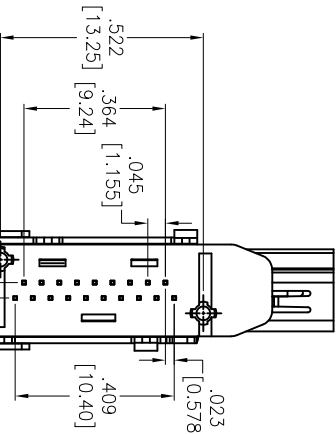

RECOMMENDED PANEL CUT

**SPECIFICATIONS:**

**Material:**  
 Housing: PBT, Glass reinforced, UL 94V-0  
 Housing color: Black  
 Spacer: Nylon46, Glass reinforced, UL 94V-0  
 Contact: Brass  
 Shield: Stainless Steel, Nickel plated  
 Plating:  
 15u" Gold over Nickel underplate on contact area,  
 Tin over Nickel underplate on PCB tails  
**Electrical:**  
 Voltage rating: 40 VAC max.  
 Current rating: 0.5 Ampere per Contact  
 Contact resistance: 10 mohms max.  
 Insulation resistance: 100 Megohm min.  
 Dielectric withstanding voltage: 500 VAC for 1 minute  
 Temperature Rating:  
 Operating temperature: -55°C to +85°C  
**Environmental:**  
 Lead free, RoHS Compliant

A

A

B

B

C

C

D

D



|  |          |
|--|----------|
| UNLESS OTHERWISE SPECIFIED<br>ALL DIMENSIONS ARE INCHES [MM] |          |
| TOLERANCES: EXCEPT AS NOTED                                  |          |
| INCHES   | HOLDS    |
| .X ± .10   | ± .10    |
| .XX ± .020   | ± .015   |
| .XXX ± .015  | ± .010   |
| .XXX ± .015  | ± .010   |
| APPROVALS  | DATE     |
| DRAWN TW   | 10/03/12 |
| CHECKED AY   | 10/03/12 |
| APPROVED   |          |

|                             |                |                                       |      |
|-----------------------------|----------------|---------------------------------------|------|
| TITLE                       |                | ADAM TECH                             |      |
| HDMI CONNECTOR, RIGHT ANGLE |                | 909 Rahway Avenue, Union, NJ 07083    |      |
| 15u" GOLD PLATED            |                | Phone: 908-687-5000 Fax: 908-687-5710 |      |
| SIZE                        | PART NO.       | SCALE                                 | REV. |
| X                           | HDMI-S-RU-1-15 | NTS                                   | A    |
| REF: S00078T                |                |                                       |      |
|                             |                | SHEET 1 OF 2                          |      |

6

5

4

3

2

1

6

5

4

3

2

1

APPROVED: \_\_\_\_\_

DATE: \_\_\_\_\_ TITLE: \_\_\_\_\_

| Rev | AWO # | Description                 | Date | Appr |
|-----|-------|-----------------------------|------|------|
|     |       | SEE SHT 1 OF 2 FOR REVISION |      |      |

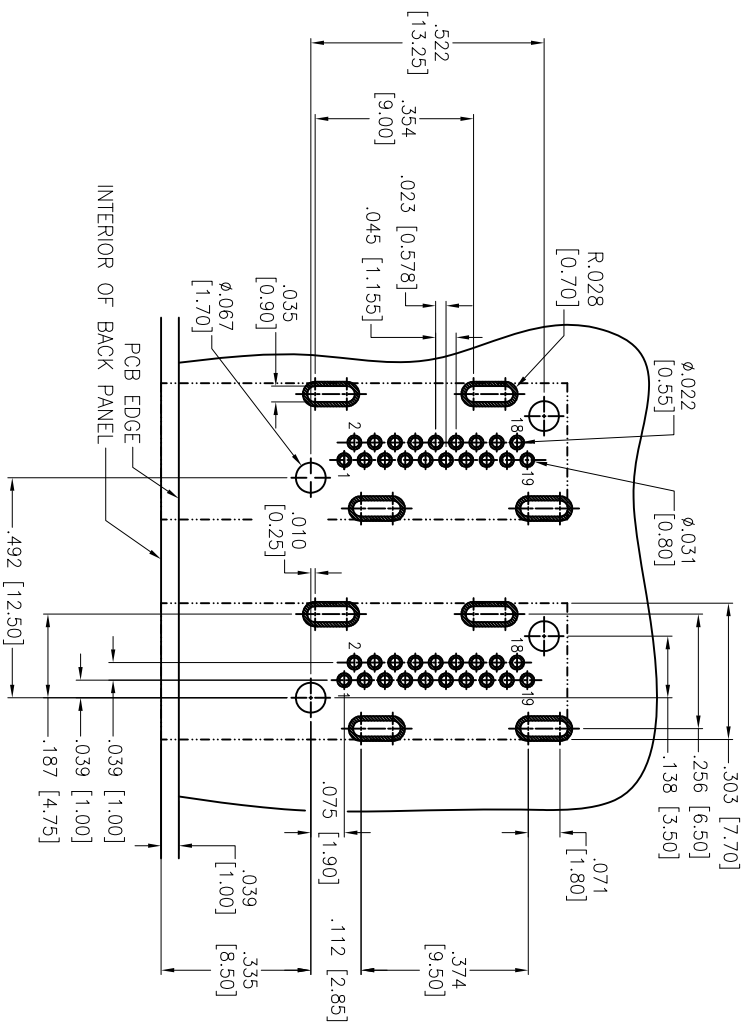

RECOMMENDED PCB LAYOUT

A

B

C

D

A

B

C

D

6

5

4

3

2

1

# ADAM TECH

909 Rahway Avenue, Union, NJ 07083  
 Phone: 908-687-5000 Fax: 908-687-5710

**HDMI CONNECTOR, RIGHT ANGLE**  
**15u" GOLD PLATED**

TITLE

UNLESS OTHERWISE SPECIFIED  
 ALL DIMENSIONS ARE IN INCHES [MM]  
 TOLERANCES: EXCEPT AS NOTED

|      |        |      |        |
|------|--------|------|--------|
| .X   | ± .10  | ØX   | ± .10  |
| .XX  | ± .020 | ØXX  | ± .015 |
| .XXX | ± .015 | ØXXX | ± .010 |

INCHES HOLE SIZE DATE

| APPROVALS  | DATE     |
|------------|----------|
| DRAWN TW   | 10/03/12 |
| CHECKED AY | 10/03/12 |
| APPROVED   |          |

| SIZE | PART NO.       | REV. |
|------|----------------|------|
| X    | HDMI-S-RU-1-15 | A    |

REF: S00078T SCALE: NTS SHEET 2 OF 2