

Rev	AWO #	Description	Date	Appr
-		RELEASED	10/15/13	

APPROVED: _____
 DATE: _____ TITLE: _____

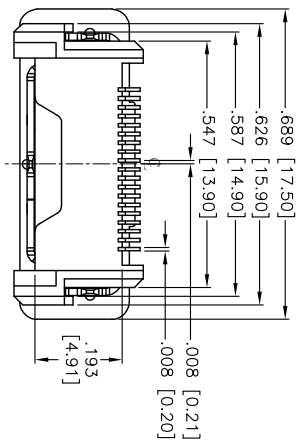
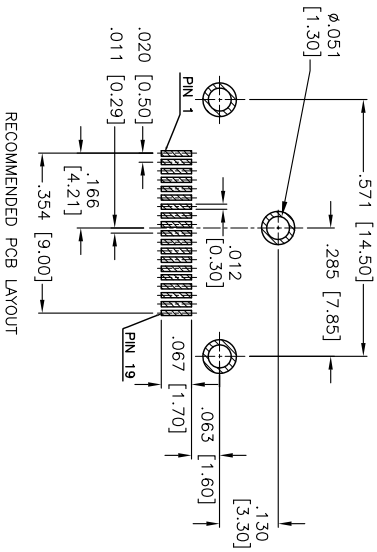
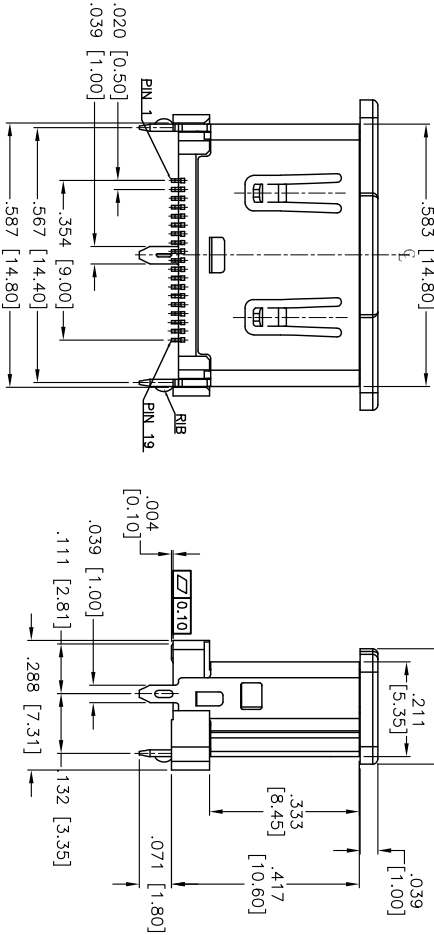
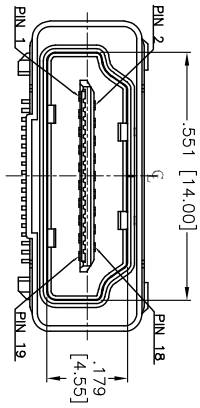

ADAM TECH
 909 Railway Avenue, Union, NJ 07083
 Phone: 908-687-5000 Fax: 908-687-5710

**HDMI RECEPTACLE, VERTICAL, SMT TYPE
 WITH DUST COVER (CAP)**

909 Railway Avenue, Union, NJ 07083
 Phone: 908-687-5000 Fax: 908-687-5710

TITLE: HDMI RECEPTACLE, VERTICAL, SMT TYPE
 WITH DUST COVER (CAP)

SIZE	PART NO.	REV.
X	HDMI-S-V-05-SMT-DC-T1R	-
REF:	SCALE: NTS	SHEET 1 OF 1

UNLESS OTHERWISE SPECIFIED
 ALL DIMENSIONS ARE INCHES [MM]
 TOLERANCES: EXCEPT AS NOTED

INCHES	HOLDS
.X ± .10	ØX ± .10
.XX ± .020	ØXX ± .015
.XXX ± .015	ØXXX ± .010
APPROVALS	DATE
DRAWN AY	10/15/13
CHECKED LW	10/15/13
APPROVED	

SPECIFICATIONS:
 Material: _____
 Housing: Hi-temp thermoplastic, UL 94V-0
 Housing color: Black
 Contact: Phosphor Bronze
 Shield: Copper Alloy, Nickel plated.
 Plating: _____
 Gold flash over Nickel underplate on contact area,
 Tin over Nickel underplate on contact tails.
 Electrical:
 Rated Voltage : AC 40V
 Rated Current: DC 0.5A
 Temperature Rating:
 Operating temperature: -25°C to +85°C
 Environmental:
 Lead free, RoHS Compliant

RECOMMENDED PCB LAYOUT

