

Rev	AWO #	Description	Date	Appr
-		RELEASED	3/5/08	

APPROVED: \_\_\_\_\_  
 DATE: \_\_\_\_\_ TITLE: \_\_\_\_\_

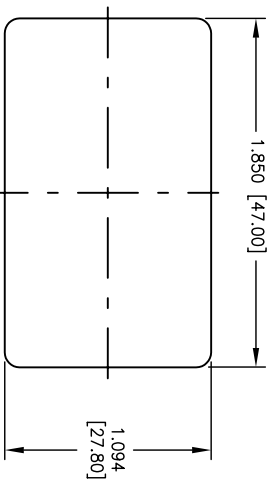
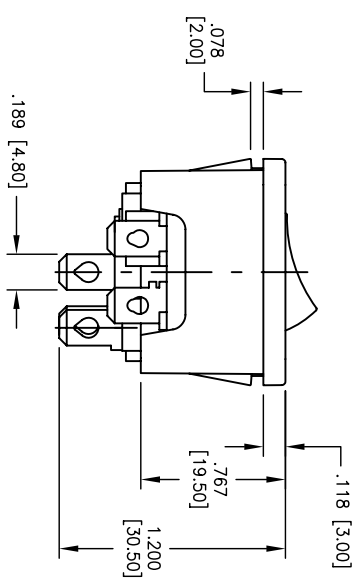
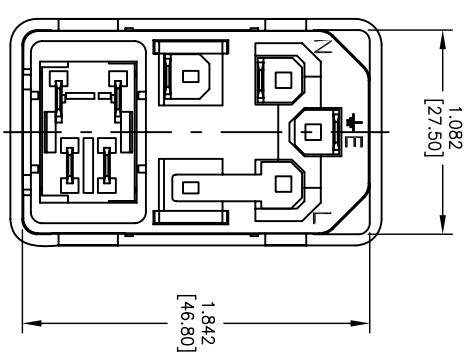
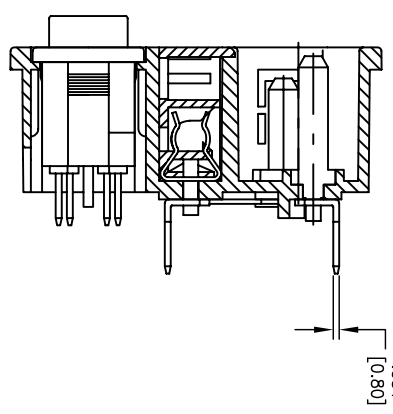
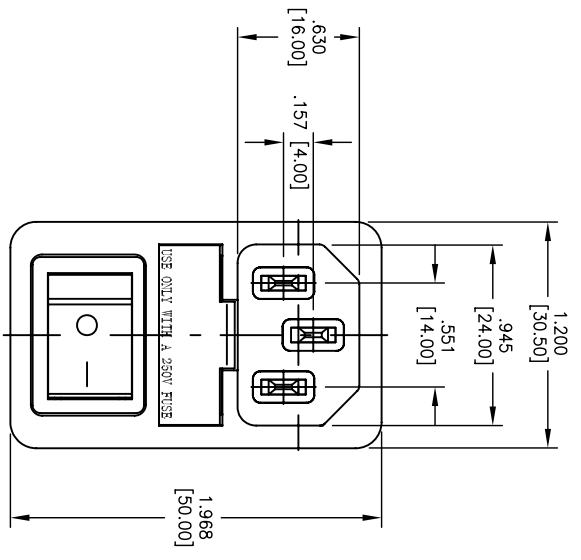

PANEL CUT-OUT

**SPECIFICATIONS:**

Material: Thermoplastic, rated UL 94V-0  
 Insulator color: Black  
 Contacts: Brass  
 Plating: Tin over Copper underplate  
 Electrical:  
 Operating voltage: 250 VAC max  
 Current rating: 15 Amps max  
 Insulation resistance: 100 Mohms min @ 500 VDC  
 Dielectric withstanding voltage: 2000 VAC for 1 minute  
 Temperature Rating: Operating temperature: -65°C to +125°C  
 Environmental: Lead free, RoHS compliant.

UNLESS OTHERWISE SPECIFIED  
 ALL DIMENSIONS ARE MM [INCHES]  
 TOLERANCES: EXCEPT AS NOTED  
 INCHES  
 X ± .10 ØX ± .10  
 .XX ± .020 ØXX ± .015  
 .XXX ± .015 ØXXX ± .010

**ADAM TECH**  
 909 Rahway Avenue, Union, NJ 07083  
 Phone: 908-687-5000 Fax: 908-687-5710  
**IEC CONNECTOR, ISOLATED FUSE**  
 2.0mm SNAP IN, .187" [4.8] QC TERMINAL

APPROVALS	DATE
SS	3/5/08
CHECKED	
APPROVED	

SIZE	PART NO.	SCALE	SHEET	REV.
X	IEC-GS-1-200	NIS	1 OF 1	