

Rev	AWO #	Description	Date	Appr
-		RELEASED	5/16/05	

APPROVED: _____
 DATE: _____ TITLE: _____

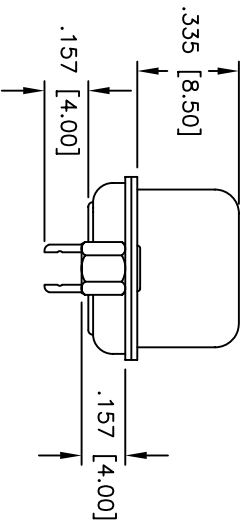
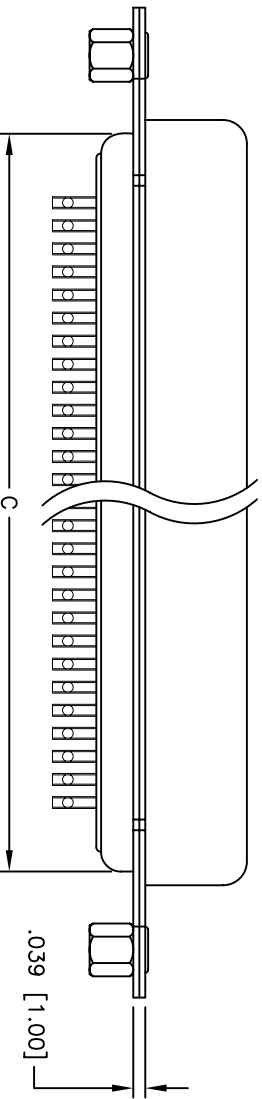
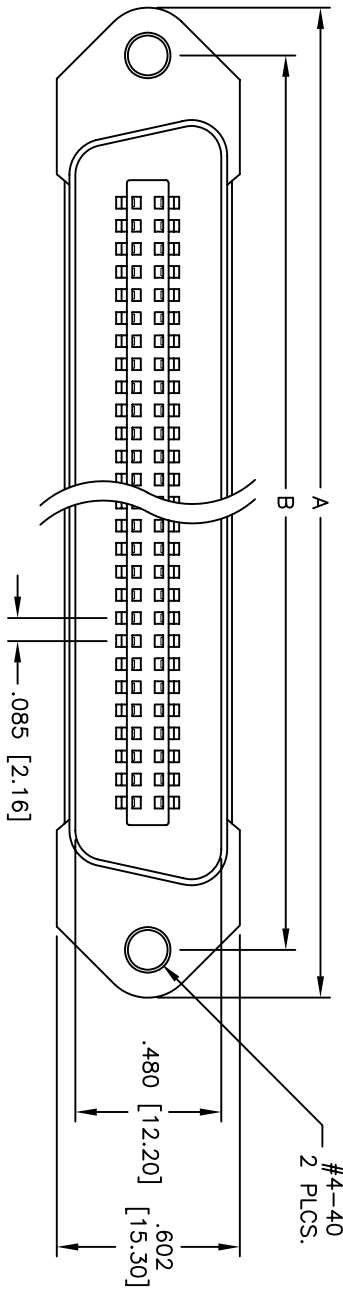

MIRXX	NO. OF CONTACTS	DIMENSIONS		
		A	B	C
MR14	14	1.728 [43.90]	1.417 [36.00]	.894 [22.70]
MR24	24	2.154 [54.70]	1.843 [46.80]	1.319 [33.50]
MR36	36	2.665 [67.70]	2.350 [59.70]	1.835 [46.60]
MR50	50	3.260 [82.80]	2.949 [74.90]	2.429 [61.70]

SPECIFICATIONS:

Material: Insulator: PBT, glass reinforced, rated UL 94V-0
 Insulator color: Blue
 Contacts: Phosphor Bronze
 Shell: Steel, Nickel plated
 Plating: Gold flush over Nickel underplate on mating area, Tin over Copper underplate on tails

Electrical:

Operating voltage: 250 VAC max
 Current rating: 1 Amp max
 Contact resistance: 35 mohms max
 Insulation resistance: 1,000 Mohms min
 Dielectric withstanding voltage: 1,000 VAC for 1 minute
 Temperature Rating: Operating temperature: -55°C to +105°C
 Environmental: Lead free, RoHS compliant
 Recommended soldering temp: 235°C for 5 seconds



ADAM TECH

909 Rahway Avenue, Union, NJ 07083
 Phone: 908-687-5000 Fax: 908-687-5710

TITLE: MINIATURE RIBBON PLUG
 SOLDER TERMINALS, #4-40 CLINCH NUTS

UNLESS OTHERWISE SPECIFIED ALL DIMENSIONS ARE INCHES [MM]	
TOLERANCES: EXCEPT AS NOTED	
INCHES	HOLDS
.X ± .10	ØXX ± .10
.XX ± .020	ØXXX ± .015
.XXX ± .015	ØXXXX ± .010
APPROVALS	DATE
DRAWN	SS
CHECKED	5/16/05
APPROVED	

SIZE	PART NO.	SCALE	SHEET 1 OF 1
X	MRXX-PA-34	NTS	
REV.			