

Rev	AWO #	Description	Date	Appr
-		RELEASED	5/19/05	
A		GENIERAL REVISION	4/19/06	
B		REDRAWN	7/31/14	AV/KW

APPROVED: \_\_\_\_\_  
 DATE: \_\_\_\_\_ TITLE: \_\_\_\_\_

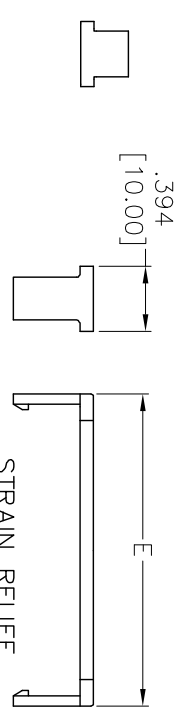
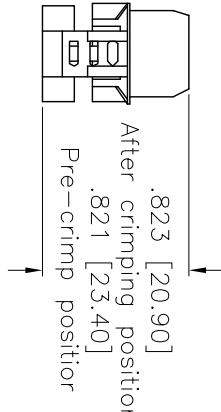
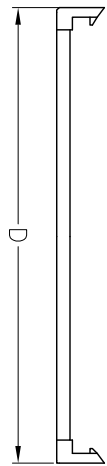
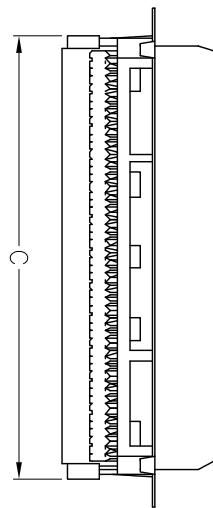
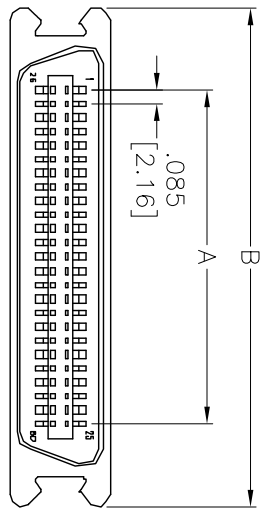

Matal shell (Male)

MRXX	NO. OF CONTACTS	DIMENSIONS				
		A	B	C	D	E
MR24	24	.935 [23.76]	1.913 [48.60]	1.398 [35.50]	1.476 [37.50]	1.476 [37.50]
MR36	36	1.446 [36.72]	2.425 [61.60]	2.098 [53.30]	2.142 [54.40]	2.315 [58.80]
MR50	50	2.041 [51.84]	3.020 [76.70]	2.697 [68.50]	2.776 [70.50]	2.791 [70.90]

UNLESS OTHERWISE SPECIFIED  
 ALL DIMENSIONS ARE INCHES [MM]  
 TOLERANCES: EXCEPT AS NOTED  
 INCHES: .X ±.10 ØXX ±.015  
 .XX ±.020 ØXXX ±.010  
 .XXX ±.015  
 APPROVALS: \_\_\_\_\_ DATE: \_\_\_\_\_

**ADAM TECH**  
 909 Rahway Avenue, Union, NJ 07083  
 Phone: 908-687-5000 Fax: 908-687-5710

DRAWN	SS	5/19/05	SIZE	PART NO.	MRXX-PF-2	REV.	B
CHECKED			X				
APPROVED			REF:	S00087T	SCALE: NTS	SHEET 1 OF 1	

**SPECIFICATIONS:**  
 Material: Insulator: PBT, Glass reinforced, rated UL 94V-0  
 Insulator color: Blue  
 Contacts: Brass  
 Shell: Steel, Nickel plated  
 Plating: Gold over Nickel underplate on contact area  
 Electrical: Operating voltage: 250 VAC max  
 Current rating: 3 Amps max.  
 Contact resistance: 20 milliohms max.  
 Insulation resistance: 1,000 Medohms min.  
 Dielectric withstanding voltage: 1,000 VAC for 1 minute  
 Environmental: Lead free, RoHS compliant.

