

6

5

4

3

2

1

APPROVED: _____
 DATE: _____ TITLE: _____

Rev	AWO #	Description	Date	Appr
-		RELEASED	5/16/05	
A		UPDATE SHAPE & DIM.	10/15/14	AY/NP
B		UPDATE DIM.	11/17/14	AY/NP

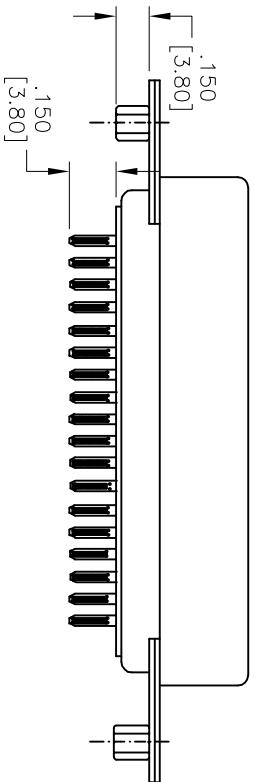
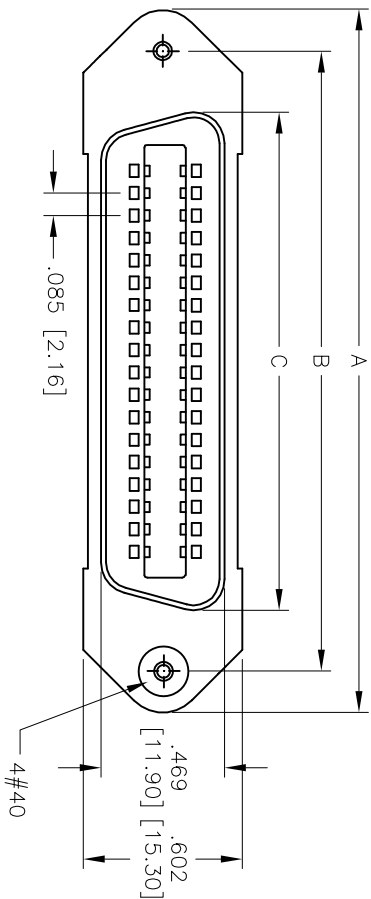

M/RXX	NO. OF CONTACTS	DIMENSIONS		
		A	B	C
MR14	14	1.728 [43.90]	1.417 [36.00]	.992 [25.20]
MR24	24	2.154 [54.70]	1.843 [46.80]	1.417 [36.00]
MR36	36	2.665 [67.70]	2.350 [59.70]	1.925 [48.90]
MR50	50	3.260 [82.80]	2.949 [74.90]	2.524 [64.10]

SPECIFICATIONS:
 Material: Insulator: PBT, glass reinforced, rated UL 94V-0
 Insulator color: Blue
 Contacts: Phosphor Bronze
 Shell: Steel, Nickel plated
 Hood: Steel, Nickel plated
 Plating: Gold flash over Nickel underplate on mating area, Tin over Copper underplate on tails

Electrical:
 Current rating: 5 Amp max
 Contact resistance: 25 mohms max
 Insulation resistance: 1,000 Mohms min
 Dielectric withstanding voltage: 1,000 VAC for 1 minute
 Operating temperature: -55°C to +105°C
 Environmental: Lead free, RoHS compliant



ADAM TECH

909 Rahway Avenue, Union, NJ 07083
 Phone: 908-687-5000 Fax: 908-687-5710

**MINIATURE RIBBON SOCKET
 SOLDER TERMINALS, #4-40 CLINCH NUTS**

UNLESS OTHERWISE SPECIFIED ALL DIMENSIONS ARE INCHES [MM] TOLERANCES: EXCEPT AS NOTED INCHES		DATE	
.X ± .10	ØXX ± .10	DATE	
.XX ± .020	ØXXX ± .015	DATE	
.XXX ± .015	ØXXXX ± .010	DATE	
APPROVALS	DATE	TITLE	
DRAWN	SS	MINIATURE RIBBON SOCKET	
CHECKED		SOLDER TERMINALS, #4-40 CLINCH NUTS	
APPROVED		SIZE	PART NO.
		X	MRXX-SA-34
		REF:	S00033T
		SCALE:	NIS
		SHEET	1 OF 1

6

5

4

3

2

1