

Rev	AWO #	Description	Date	Appr
-		RELEASED	5/17/05	
A		REDRAWN	02/29/12	
B		REVISED DIM.	5/14/15	AY/KW

APPROVED: _____
 DATE: _____ TITLE: _____

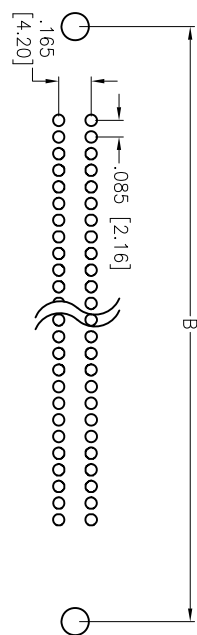

RECOMMENDED PCB LAYOUT

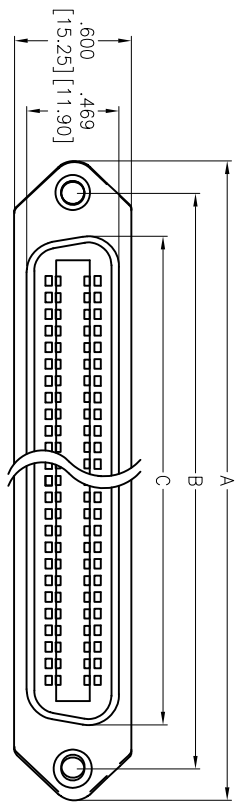
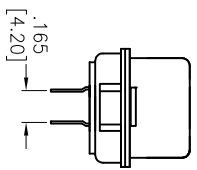
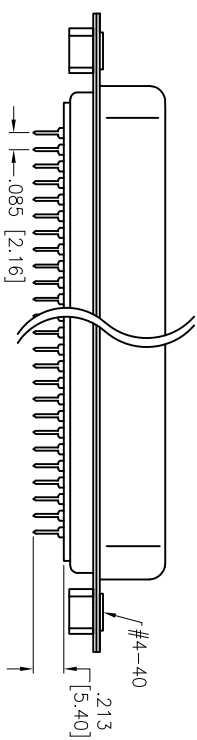

M/R	NO. OF CONTACTS	A	B	C
MRXX				
MR14	14	1.729 [43.92]	1.417 [35.99]	.992 [25.20]
MR24	24	2.154 [54.71]	1.842 [46.79]	1.417 [36.00]
MR36	36	2.665 [67.69]	2.352 [59.74]	1.925 [48.90]
MR50	50	3.259 [82.78]	2.947 [74.85]	2.520 [64.00]

SPECIFICATIONS:

Material: Insulator: PBT, glass reinforced, rated UL 94V-0
 Insulator color: Blue
 Contacts: Brass
 Shell: Cold Rolled Steel, Nickel plated
 Plating:
 Gold flash over Nickel underplate on mating area,
 Tin over Copper underplate on tails
 Electrical:
 Current rating: 1 Amp max
 Contact resistance: 30 mohms max
 Insulation resistance: 500 Mohms min
 Dielectric withstanding voltage: 500 VAC for 1 minute
 Temperature Rating:
 Operating temperature: -55°C to +105°C
 Environmental:
 Lead free, RoHS compliant



ADAM TECH

909 Rahway Avenue, Union, NJ 07083
 Phone: 908-687-5000 Fax: 908-687-5710

TITLE: MINIATURE RIBBON SOCKET
 PCB TERMINALS, #4-40 CLINCH NUTS

UNLESS OTHERWISE SPECIFIED ALL DIMENSIONS ARE INCHES [MM]		TOLERANCES: EXCEPT AS NOTED	
.X	± .10	ØXX	± .10
.XX	± .020	ØXXX	± .015
.XXX	± .015	ØXXXX	± .010
APPROVALS		DATE	
DRAWN	SS	5/17/05	
CHECKED			
APPROVED			
SIZE	PART NO.	REF:	SCALE: NTS
X	MRXX-SC-34	S00001T	
REV.		SHEET	1 OF 1
B			