

Rev	AWO #	Description	Date	Appr
-		RELEASED	5/18/05	
A		REDRAWN	4/15/11	
B		REVISED CURRENT RATING	5/21/12	

APPROVED: _____
 DATE: _____ TITLE: _____

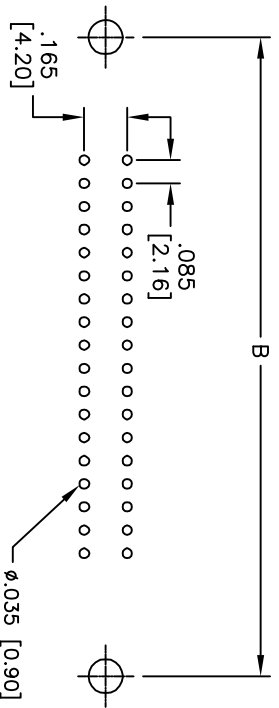

RECOMMENDED
PCB LAYOUT

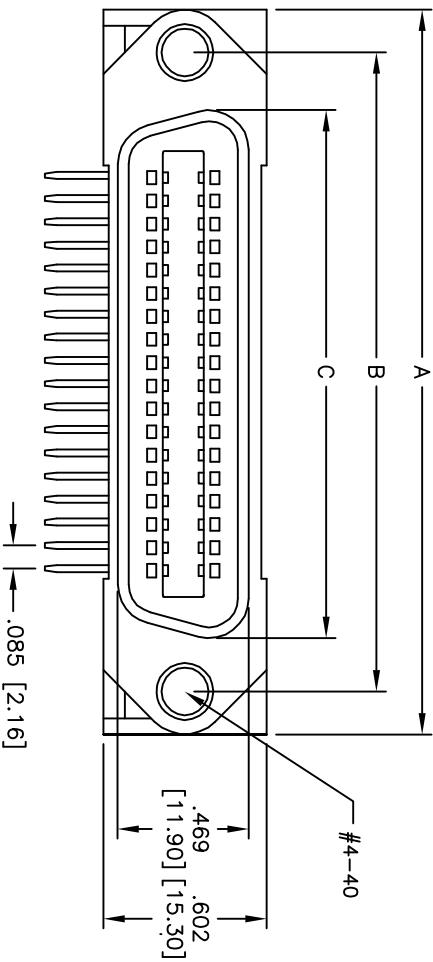
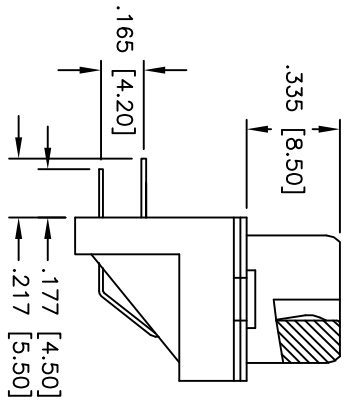
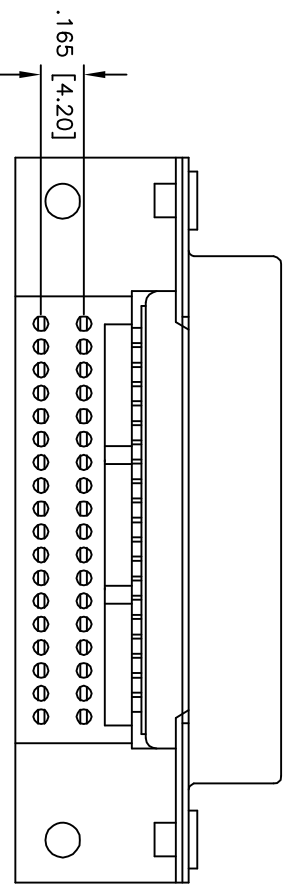

MIRXX	NO. OF CONTACTS	DIMENSIONS		
		A	B	C
MR14	14	1.728 [43.90]	1.417 [36.00]	.992 [25.20]
MR24	24	2.154 [54.70]	1.843 [46.80]	1.417 [36.00]
MR36	36	2.665 [67.70]	2.350 [59.70]	1.925 [48.90]
MR50	50	3.260 [82.80]	2.949 [74.90]	2.524 [64.10]

SPECIFICATIONS:

Material: Insulator: PBT, glass reinforced, rated UL 94V-0
 Insulator color: Blue
 Contacts: Phosphor Bronze
 Shell: Steel, Nickel plated

Plating: Gold flash over Nickel underplate on mating area,
 Tin over Copper underplate on tails
 Electrical: Current rating: 1 Amp max
 Contact resistance: 25 mohms max
 Insulation resistance: 1,000 Mohms min
 Dielectric withstanding voltage: 1,000 VAC for 1 minute
 Temperature Rating: Operating temperature: -55°C to +105°C
 Environmental: Lead free, RoHS compliant



ADAM TECH

909 Rahway Avenue, Union, NJ 07083
 Phone: 908-687-5000 Fax: 908-687-5710

MINIATURE RIBBON SOCKET
 RIGHT ANGLE PCB, #4-40 INSERTS

UNLESS OTHERWISE SPECIFIED ALL DIMENSIONS ARE INCHES [MM] TOLERANCES: EXCEPT AS NOTED		TITLE	
INCHES	HOLES	MINIATURE RIBBON SOCKET	
.X ± .10	ØXX ± .10	SIZE	PART NO.
.XX ± .020	ØXXX ± .015	X	MRXX-SD-34
.XXX ± .015	ØXXXX ± .010	REF:	S00033T
APPROVALS	DATE	SCALE:	NTS
DRAWN	SS	5/18/05	
CHECKED			
APPROVED			
		SHEET	1 OF 1