

Rev	Description	Date	Appr
0	Released	2/24/04	

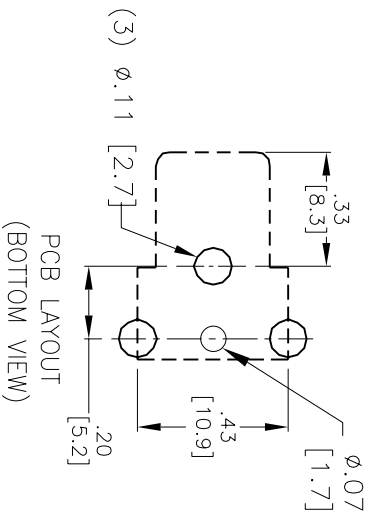
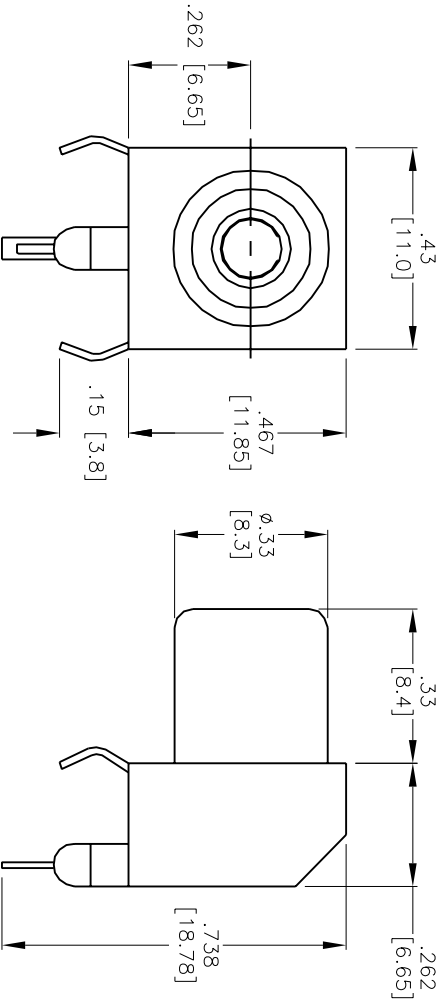
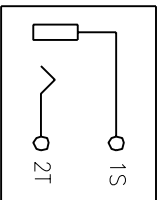

DESCRIPTION	MATERIAL	FINISH
INSULATOR	PBT	SEE CHART
BODY	0.4T STEEL	GOLD PLATING
TERMINAL	0.25T BRASS	GOLD PLATING
BARREL	0.3T STEEL	GOLD PLATING

P/N	COLOR
RCA-1-B-GA	BLACK
RCA-1-R-GA	RED
RCA-1-W-GA	WHITE
RCA-1-Y-GA	YELLOW

# ADAM TECH

Dimension in IN [MM]

Tolerance

(Unless Otherwise Specified)  
 .XX ± .01  
 .XXX ± .005

DRAWN : SS

APPR : -

SCALE :

DESCRIPTION :  
RCA Jack

PART NUMBER :  
RCA-1-X-GA

SHEET 1 OF 1 SHEETS

LOG

REF.

REV.

**SPECIFICATIONS:**

**ELECTRICAL:**

Operation voltage: 250 VAC max

Current rating: 1 Amp max

Contact resistance: 50 mohm max

Insulation resistance: 100 Mohm min @ 500 VDC

Dielectric withstanding voltage: 500 VAC min rms for 1 minute

**ENVIRONMENTAL:**

Operating temperature: -65°C to +125°C

Date: 02/24/04