

Rev	AWO #	Description	Date	Appr
-		RELEASED	3/20/08	

APPROVED: _____
 DATE: _____ TITLE: _____

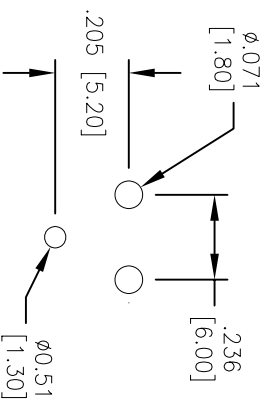
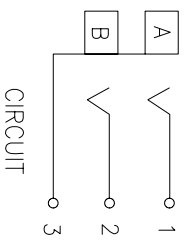
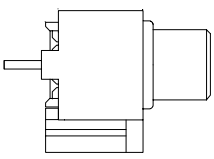
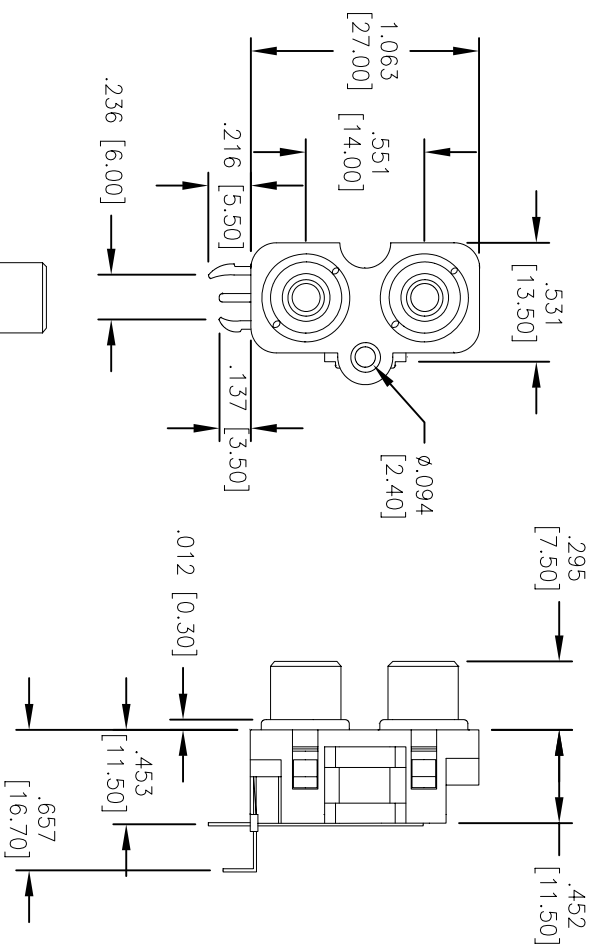

RECOMMENDED PCB LAYOUT

SPECIFICATIONS:

Material:

- Insulator: ABS, Rated UL 94HB
- Cover: ABS, Rated UL 94HB
- Base: ABS, Rated UL 94HB
- Insulator colors: Red & White
- Bushing: Brass, Nickel plated
- Contacts: Brass

Plating:

- Tin over Copper underplate.

Electrical:

- Operating voltage: 12 VDC max.
- Current rating: 1 Amp max.
- Contact resistance: 30 mohms max. initial
- Insulation resistance: 100 Mohms min.
- Dielectric withstanding voltage: 500 VAC for 1 minute
- Temperature Rating:
- Operating temperature: -25°C to +85°C
- Environmental:
- Lead free, RoHS compliant.
- Recommended soldering temp: 235°C for 5 sec.



ADAM TECH

909 Rahway Avenue, Union, NJ 07083
 Phone: 908-687-5000 Fax: 908-687-5710

TITLE: RCA JACK, RIGHT ANGLE, 2 PORT,
 PCB MOUNT TOP WHITE / BOTTOM RED

UNLESS OTHERWISE SPECIFIED ALL DIMENSIONS ARE IN INCHES [MM] TOLERANCES UNLESS NOTED INCHES		DATE	
X .XX ± .10	ØXX ± .015	SS	3/20/08
.XXX ± .015	ØXXX ± .010	CHECKED	
APPROVED		APPROVED	
SIZE X	PART NO. RCA-8-4A-W/R	REV. -	
REF:	SCALE: NTS	SHEET 1 OF 1	