

Rev	AWO #	Description	Date	Appr
-		RELEASED	11/14/13	

APPROVED: _____ TITLE: _____
 DATE: _____

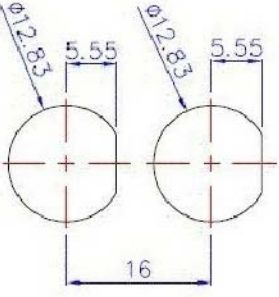
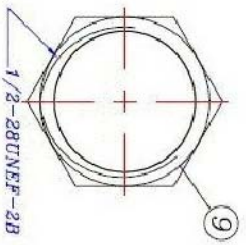
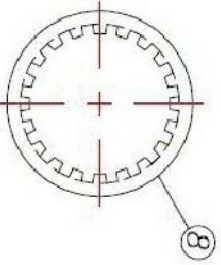
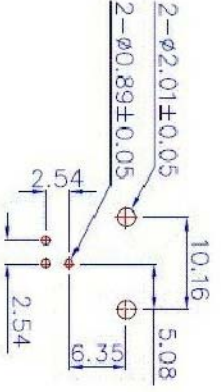
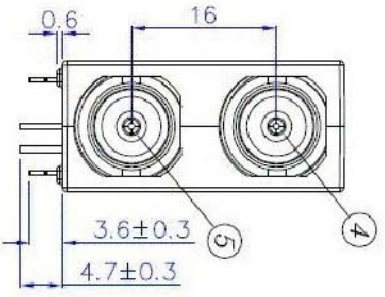
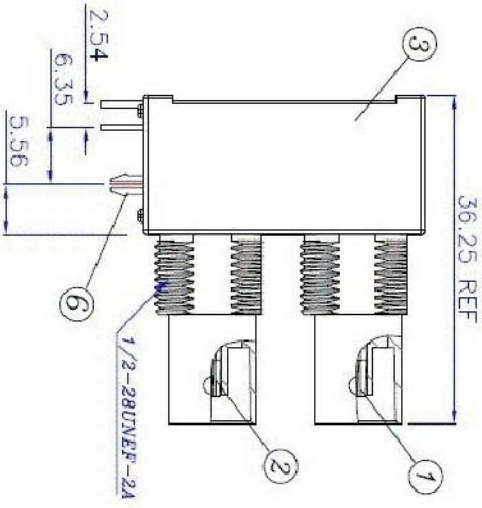
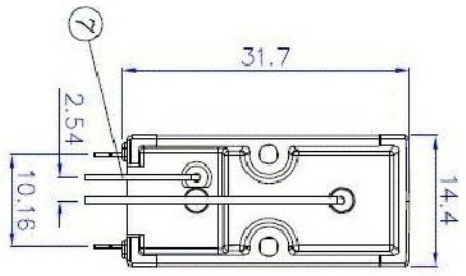

RECOMMENDED PC BOARD LAYOUT
 WITHOUT MOUNTING POSTS

LOCK WASHER

CLAMP NUT

RECOMMENDED MOUNTING HOLE
 MAXIMUM PANEL THICKNESS: 5.5MM

SPECIFICATIONS

- Material:
 1. Center Contact: Phosphor Bronze, Gold and Tin plated.
 2. Center Contact: Phosphor Bronze, Gold plated.
 3. Body: Zinc Alloy, Nickel Plated
 4&5. Insulator: PE-606.
 6. Mounting Post: Bronze, Nickel Plated
 7. Solder Tail: Copper Wire, Tin plated
 8. Washer: Steel, Nickel Plated
 9. Nut: Brass, Nickel Plated
- Electrical:
 Nominal Impedance: 75 ohms
 Frequency range: 0-1 GHz
 Contact Resistance: 3 Milliohms max. (Center Contact)
 2 Milliohms max. (Outer Contact)
- Insulator Resistance: 5000 Megohms min.
 Environmental:
 Lead free, RoHS compliant.

ADAM TECH

909 Rahway Avenue, Union, NJ 07083
 Phone: 908-687-5000 Fax: 908-687-5710

TITLE
 DUAL PORT BNC, R/A PCB MOUNT,
 75 OHM IMPEDANCE

UNLESS OTHERWISE SPECIFIED ALL DIMENSIONS ARE MM [INCHES] TOLERANCES: EXCEPT AS NOTED	
INCHES	HOLES
X ± .10	ØXX ± .10
XX ± .020	ØXXX ± .015
XXX ± .015	ØXXXX ± .010
APPROVALS	DATE
DRAWN AY	11/14/13
CHECKED GC	11/14/13
APPROVED	

SIZE	PART NO.	REV.
X	RF-1-01D-P-00-75-M-HDW	
REF:	S00049T	SCALE: NTS
		SHEET 1 OF 1

6 5 4 3 2 1

A B C D