

Rev	AWO #	Description	Date	Appr
-	12407	RELEASED	08/21/12	

APPROVED: _____ TITLE: _____

DATE: _____

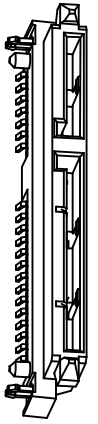
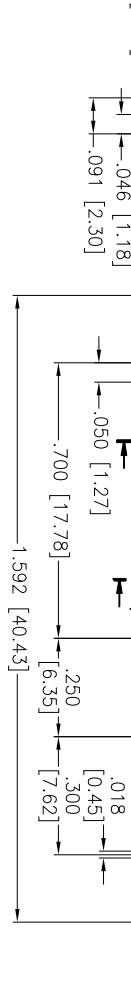
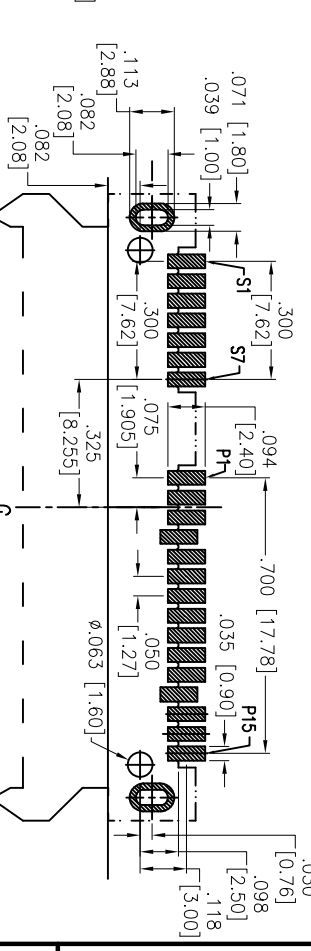
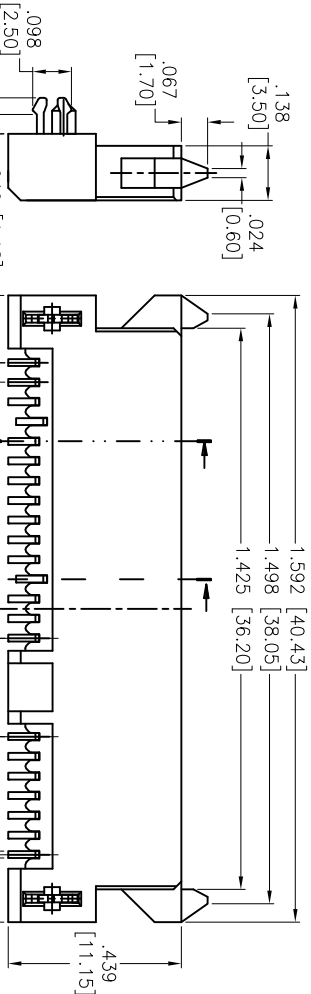
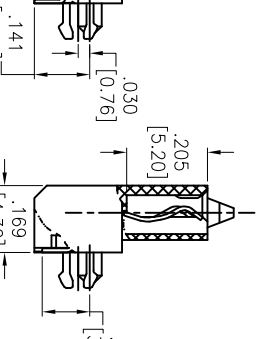
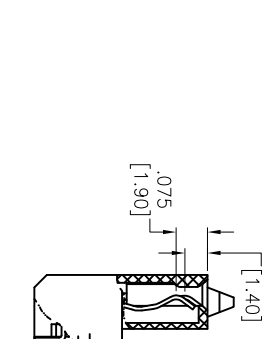
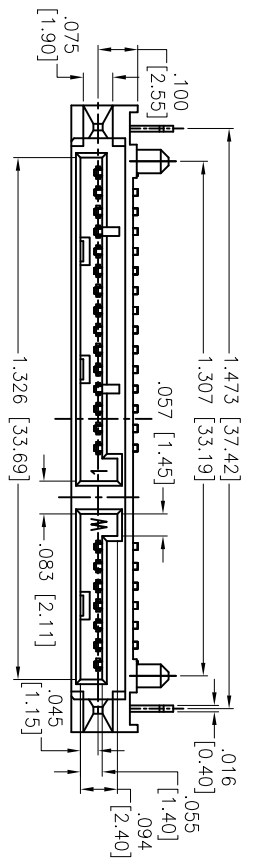

Signal Segment			Power Segment		
Name	Type	Segment	Name	Type	Segment
S1	GND	P9	V5		
S2	A+	P10	GND		
S3	A-	P11	DAS/DSS		
S4	GND	P12	GND		
S5	B-	P13	V12		
S6	B+	P14	V2		
S7	GND	P15	V12		

SPECIFICATIONS:
Material:
 Insulator: Hi-Temp Thermoplastic, rated UL 94V-0
 Insulator color: Black
 Contacts: Phosphor Bronze
 Plating:
 15u" Gold over Nickel underplate on contact area,
 Tin over Copper underplate on solder tails
Electrical:
 Current rating: 1.5 Amps max
 Contact resistance: 30 mohms max
 Insulation resistance: 1,000 Mohms min @ 500 VDC
 Dielectric withstanding voltage: 500 VAC for 1 minute
Mechanical:
 Insertion force: 45N max.
 Withdrawal force: 10N min.
 Durability: 500 cycles
 Temperature Rating:
 Operating temperature: -55°C to +85°C
Environmental:
 Lead free, RoHS compliant

UNLESS OTHERWISE SPECIFIED
 ALL DIMENSIONS ARE IN INCHES [MM]
 TOLERANCES: EXCEPT AS NOTED
 INCHES HOLES
 .X ±.10 Ø.X ±.10
 .XX ±.020 Ø.XX ±.015
 .XXX ±.015 Ø.XXX ±.010
APPROVALS
 DRAWN TW 08/21/12
 CHECKED AY 08/21/12
 APPROVED

ADAM TECH

909 Rahway Avenue, Union, NJ 07083
 Phone: 908-687-5000 Fax: 908-687-5710

TITLE: SATA CONNECTOR, 7P + 15P, 90°,
 REVERSE SURFACE MOUNT FEMALE

REF: S00078T	SCALE: NTS	SHEET 1 OF 1
--------------	------------	--------------

