

6	5	4	3	2	1
Rev	AWO #	Description	Date	Appr	
-		RELEASED	5/15/13		

APPROVED: _____

DATE: _____ TITLE: _____

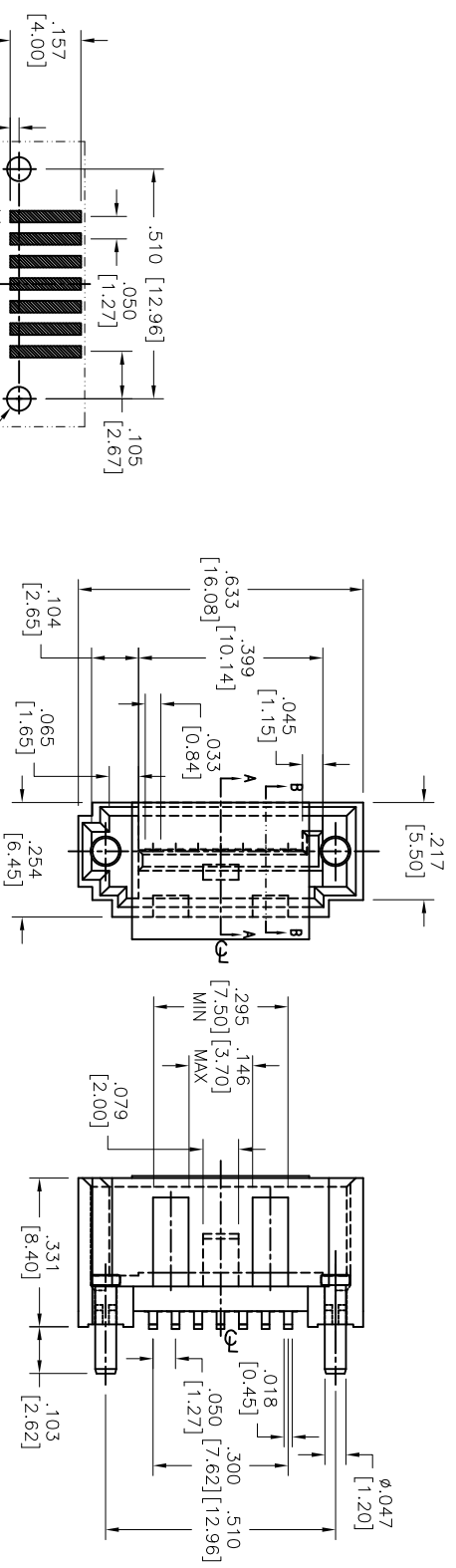

RECOMMENDED PCB LAYOUT

SPECIFICATIONS:

Material: Insulator: Hi-temp thermoplastic, rated UL 94V-0

Insulator color: Black

Contacts: Brass

Boardlock: Brass, Tin plated

Plating:

15u" Gold over Nickel underplate on mating area, Tin over Copper underplate on tails

Electrical:

Current rating: 1.5 Amps max.

Contact resistance: 30 mohms max.

Insulation resistance: 1,000 Mohms min @ 500 VAC

Dielectric withstanding voltage: 500 VAC for 1 minute

Mechanical:

Insertion force: 45N max

Withdrawal force: 10N min

Durability: 500 cycles

Temperature Rating: Operating temperature: -55°C to +85°C

Environmental: Lead free, RoHS compliant.

PACKAGED ON TAPE & REEL

ADAM TECH

909 Railway Avenue, Union, NJ 07083
Phone: 908-687-5000 Fax: 908-687-5710

TITLE: SATA 7P STRAIGHT DIP A TYPE SHIELD
ROUNDED COPPER POLE(THROUGH TYPE) MALE

UNLESS OTHERWISE SPECIFIED ALL DIMENSIONS ARE INCHES [MM] TOLERANCES EXCEPT AS NOTED		INCHES		HOLE SIZES	
.X	± .10	ØX	± .10	ØXXX	± .015
.XX	± .020	ØXXX	± .015	ØXXX	± .010
.XXX	± .015	ØXXX	± .010		
APPROVALS		DATE		TITLE	
DRAWN	AY	5/15/13		SIZE	PART NO.
CHECKED	EH	5/15/13		X	SATA-P-PR-1-SMT-15-KT-T/R
APPROVED				REF:	S00078T
				SCALE:	NTS
				SHEET	1 OF 1