

APPROVED: \_\_\_\_\_  
 DATE: \_\_\_\_\_ TITLE: \_\_\_\_\_

| Rev | AWO # | Description   | Date     | Appr |
|-----|-------|---------------|----------|------|
| -   |       | RELEASED      | 11/21/12 |      |
| A   |       | UPDATED TITLE | 10/8/15  | SS   |

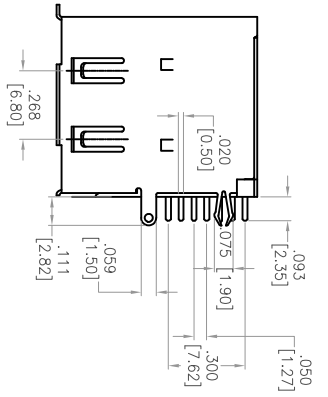

| Signal Name | Pin Number | ESATA |
|-------------|------------|-------|
| S1          | GND        | ESATA |
| S2          | RX+        |       |
| S3          | RX-        |       |
| S4          | GND        |       |
| S5          | TX-        |       |
| S6          | TX+        |       |
| S7          | GND        |       |

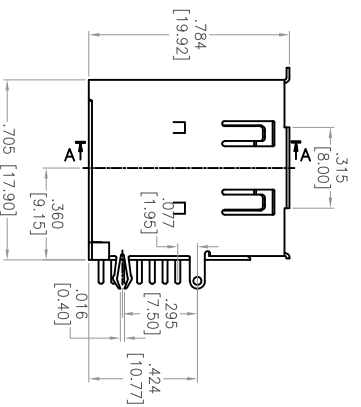
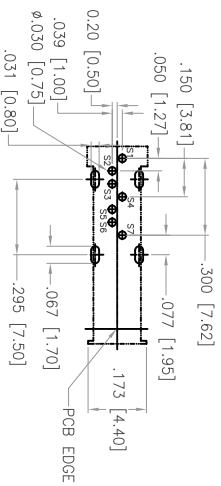
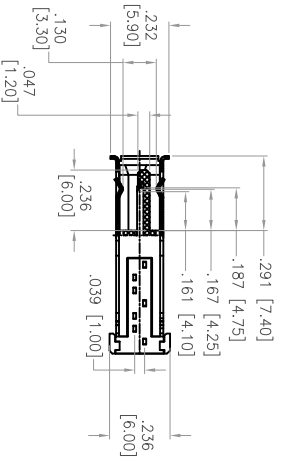
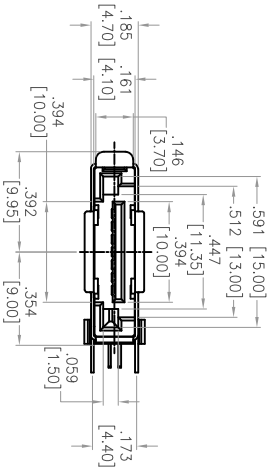
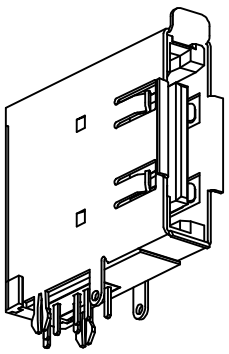

RECOMMENDED PCB LAYOUT

**SPECIFICATIONS:**

Material: Insulator: Hi-temp thermoplastic, rated UL 94V-0

Insulator color: Black

Contacts: Brass

Plating:

Gold Flash over Nickel underplate on contact area, Tin over Copper underplate on solder tails

Electrical:

Current rating: 1.5 Amps per contact

Contact resistance: 30 mohms max

Insulation resistance: 1000 Mohms min

Dielectric withstanding voltage: 500 VAC

Temperature Rating:

Operating temperature: -55°C to +125°C

Environmental:

Lead free, RoHS compliant



UNLESS OTHERWISE SPECIFIED  
 ALL DIMENSIONS ARE INCHES [MM]  
 TOLERANCES: EXCEPT AS NOTED  
 INCHES HOLES ±.10  
 .XX ±.020 ØXXX ±.015  
 .XXX ±.015 ØXXX ±.010

**ADAM TECH**  
 909 Rahway Avenue, Union, NJ 07083  
 Phone: 908-687-5000 Fax: 908-687-5710

| APPROVALS  | DATE     | TITLE   | SIZE | PART NO.     | SCALE | SHEET  | REV. |
|------------|----------|---|------|--------------|-------|--------|------|
| DRAWN AY   | 11/21/12 | ESATA CONNECTOR, 7 PIN, RIGHT ANGLE UPRIGHT, DIP TYPE | X    | SATA-W-NP-RU | NIS   | 1 OF 1 | A    |
| CHECKED YC | 11/21/12 |   |      |              |       |        |      |
| APPROVED   |          |   |      |              |       |        |      |